

# LBCC

LINN-BENTON COMMUNITY COLLEGE

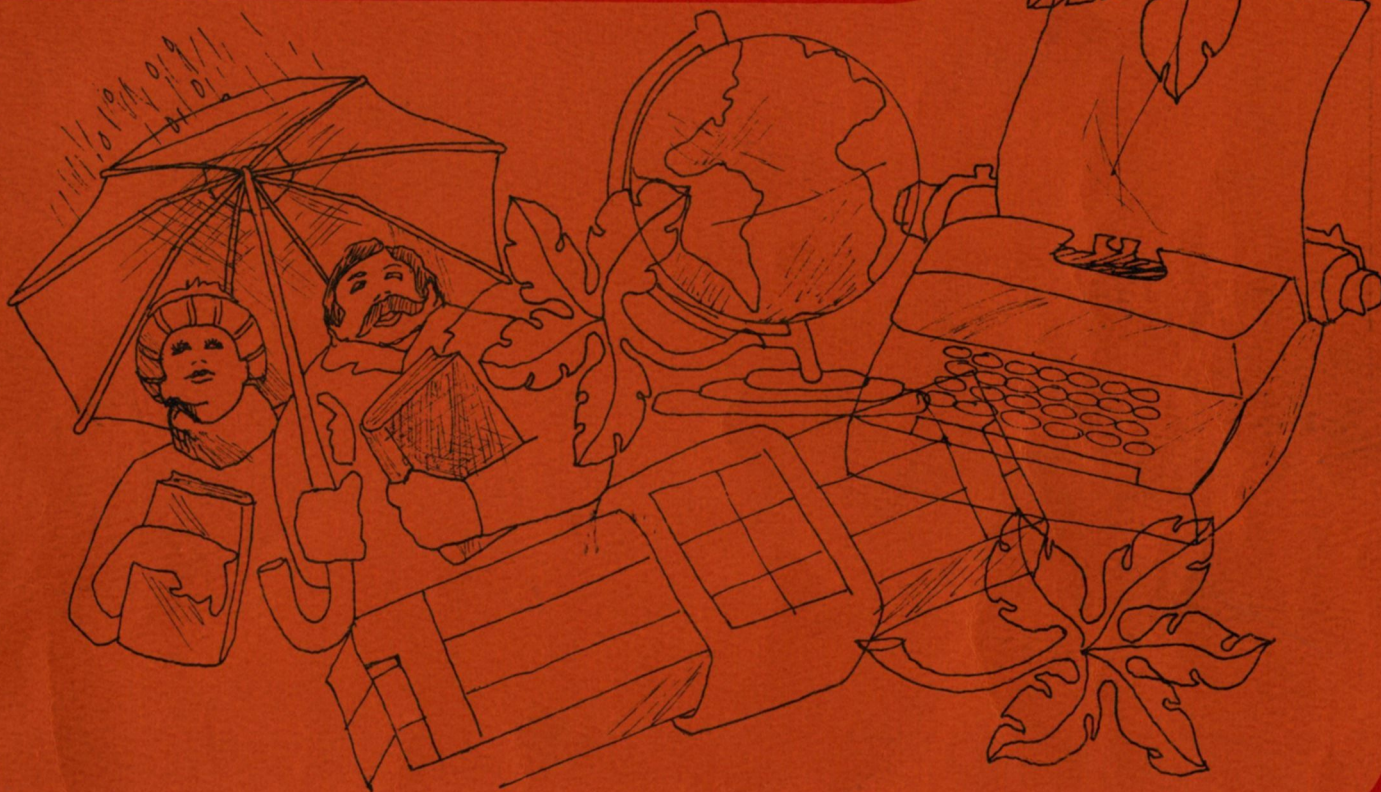

## CREDIT CLASS SCHEDULE

LBCC DAY AND EVENING CREDIT CLASSES THROUGHOUT THE TWO COUNTY AREA

# FALL 1975

# CAMPUS MAP

## Business

LOWER LEVEL  
Data Processing  
Business Management  
Supervisory Training  
Accounting Technology  
UPPER LEVEL  
Secretarial Skills  
Accounting Technology

## Humanities

LOWER LEVEL  
Visual Arts  
Language Arts  
UPPER LEVEL  
Performing Arts  
Language Arts

## Industrial A

LOWER LEVEL  
Automotive Technology  
Auto Body Repair  
Welding  
Metallurgy  
UPPER LEVEL  
Wastewater Technology  
Electricity & Electronics  
Technology  
Heating, Air Conditioning &  
Refrigeration Technology  
Home Economics  
Human Services

## Industrial B

Machine Tools  
Recreational Vehicle Repair  
Wood Technology

## Science-Technology

LOWER LEVEL  
Physical Sciences  
Mathematics  
Environmental Technology  
UPPER LEVEL  
Agri-business  
Farm Records Management  
Biology  
Drafting  
Metallurgy



## Learning Resource Center

LOWER LEVEL  
Library  
Graphic Services  
Media Services  
UPPER LEVEL  
Study Skills  
Reading Lab  
Math-Media Lab  
Classrooms  
Adult Basic Education-GED  
4-C's Council

## Forum

400-seat Lecture Hall  
Two 90-seat Lecture Rooms  
Speech and Drama  
Journalism  
Graphic Communications

## College Center

LOWER LEVEL  
Public Reception Area  
President's Office  
Office of Public Information  
Board Room  
Student Services  
Admissions  
Registration  
Counseling  
Financial Aids  
Job Placement  
Veterans Office  
Health Service  
Business Office  
Bookstore  
Cooperative Work Experience  
Community Education  
Apprenticeship  
Disadvantaged and  
Handicapped

UPPER LEVEL  
English and Journalism  
Student Government  
Dining  
Food Preparation  
Recreation  
College Center Office  
Room Reservations  
Lost and Found  
Campus Calendaring  
Posters  
Housing  
Voter Registration  
Ticket Sales  
Student Activities  
Lockers

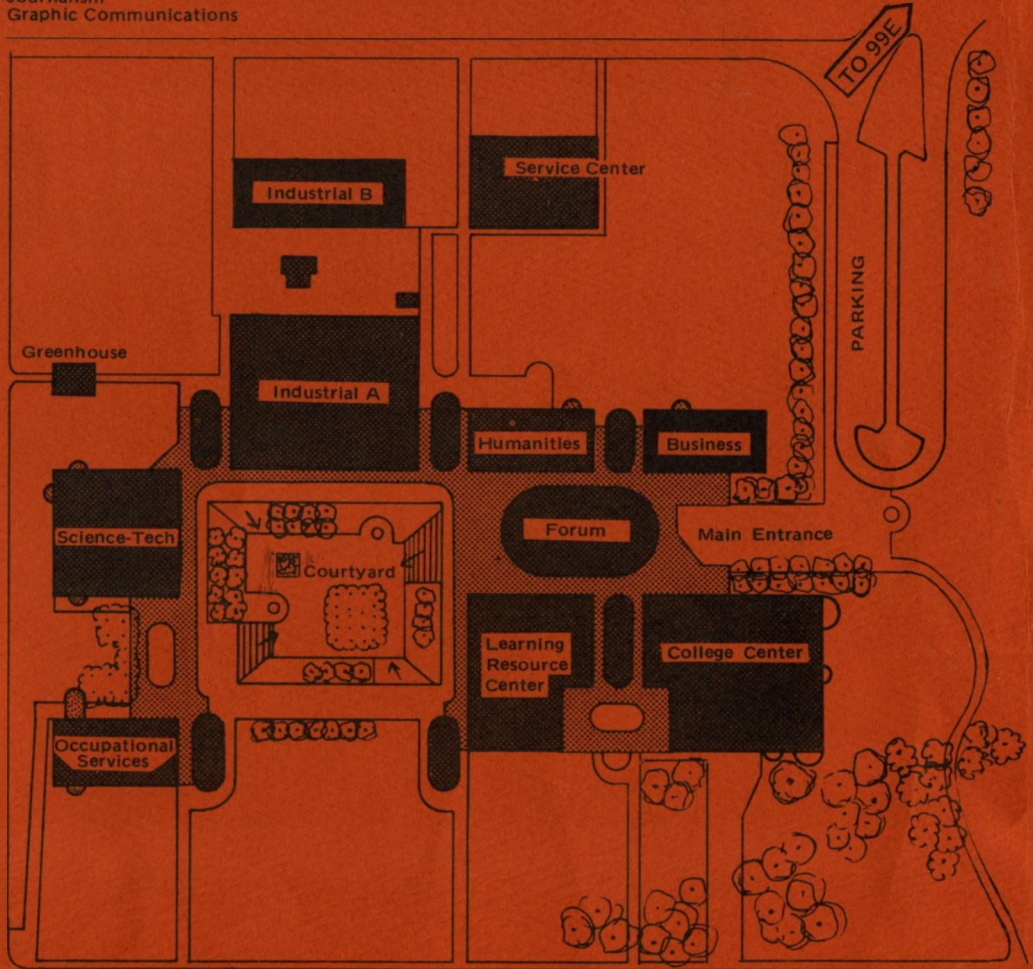

## Occupational Services

LOWER LEVEL  
Associate Degree Nursing  
Nursing Assistant  
Criminal Justice  
UPPER LEVEL  
Social Sciences  
Dental Assistant

## Activities Center

Gymnasium  
Activity Room  
Physical Education

PARKING

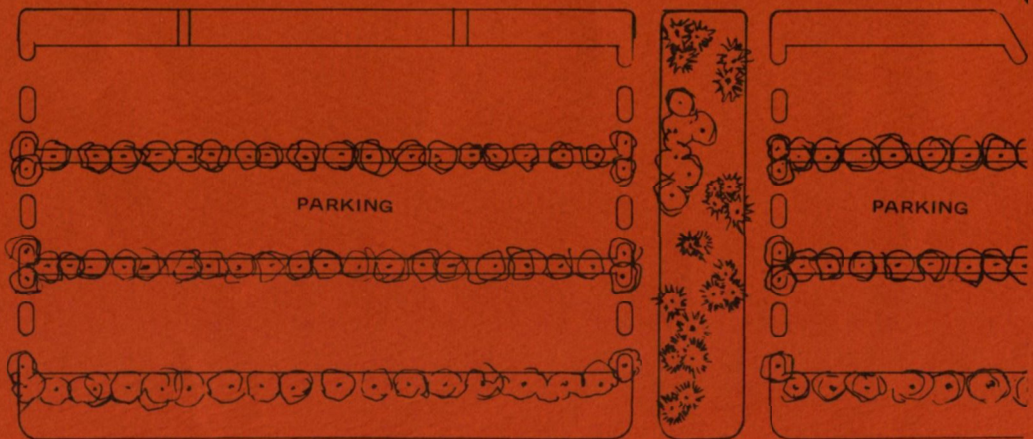

ALLEN LANE

TO 99E

SCHEDULE SUPPLEMENT - FALL TERM 1975  
SUPPLEMENT III

ADDED CLASSES

<u>TLN</u>	<u>COURSE #</u>	<u>COURSE TITLE</u>	<u>CREDITS</u>	<u>DAYS</u>	<u>TIME</u>	<u>DUR.</u>	<u>ROOM</u>	<u>INSTRUCTOR</u>
3186	4.151	Weld I (Auto)	03	F	12:00	5	IA105	Staff
4161	3.490	App. Mech.	03	M W F	1:00	1	ST219	Collett
4406	MT203	Calculus	04	TBA				Reed
4484		Rec. III		H	1:00		ST102	Kraft
6166	9.743	Inc Tx Prep	03	T	7:00N	3	CHS112	Woodmark

CHANGES

- 2060 Thurs., 8:00 am, 4 hrs. (Lab day, time & duration change)
- 2235 Monday & Wednesday, AC159W (days & room change)
- 2905 Tuesday & Thursday, 3:00 pm, 1.5 hrs. (days, time & dur. change)
- 2925 Mon. & Wed., 2:00 (days & time change)
- 3145 3 credits (credit change)
- 3830 RE201 (course no. change)
- 4161 add prerequisite: Tech Math III, Prac. Physics
- 4310 Jabe (instructor change)
- 4315 Rodia (instructor change)
- 4488 ST109 (room change)
- 6051 0.688 (course no. change)
- 6070 Benedict (instructor change)

CANCELLED CLASSES

- 4160
- 4775

SCHEDULE SUPPLEMENT - FALL TERM 1975  
SUPPLEMENT II

ADDED CLASSES

<u>TLN</u>	<u>COURSE #</u>	<u>COURSE TITLE</u>	<u>CREDITS</u>	<u>DAYS</u>	<u>TIME</u>	<u>DUR.</u>	<u>ROOM</u>	<u>INSTRUCTOR</u>
2706	2.515	Business Math	03	T-H	7:00N	2.5	B211	Staff
2707	2.521	Office Machines	03	T-H	7:00N	2.5	B211	Staff
2708	2.522	Adv. Off. Machines	03	T-H	7:00N	2.5	B211	Staff
2956	3.511	Auto Body Rpr. I special admissions procedure	12	MTWHF	6:30N	4	1A224	Staff
2957	3.512	Auto Body Rpr. II special admissions procedure	12	MTWHF	6:30N	4	1A224	Staff
2958	3.513	Auto Body Rpr. III special admissions procedure	12	MTWHF	6:30N	4	1A224	Staff
2986	3.514	Auto Body Rpr. IV special admissions procedure	12	MTWHF	6:30N	4	1A224	Staff
2987	3.515	Auto Body Rpr. V special admissions procedure	12	MTWHF	6:30N	4	1A224	Staff
2988	3.516	Auto Body Rpr. VI special admissions procedure	12	MTWHF	6:30N	4	1A224	Staff
2993	3.296	Auto Mechanics II special admissions procedure		TBA			1A117	Staff
3196	4.153	Welding Seminar variable credit 1-4		TBA				Alvin
6081	6.158	Sanitation Seminar \$26.25	03	M	7:00N	3	LRC211	May

CHANGES

2005 8:00am (time change)  
 3560 add prerequisite: WR242  
 3815 MWF; 9:00am; 1 hr. (days, time, and duration change)  
 3855 Williamson (instructor change)  
 4275 2.5 hrs. (duration change)

CANCELLED CLASSES

6080  
 6085

SCHEDULE SUPPLEMENT - FALL TERM 1975  
SUPPLEMENT I

ADDED CLASSES

<u>TLN</u>	<u>COURSE #</u>	<u>COURSE TITLE</u>	<u>CREDITS</u>	<u>DAYS</u>	<u>TIME</u>	<u>DUR.</u>	<u>ROOM</u>	<u>INSTRUCTOR</u>	
6021	9.305	Ind. Safety \$26.25	03	W	7.00N	3.0	LRC209	Grant	PNP
6031	9.742	Switchbrd Recept Techniques 6 wks. Starts 9/30/75	02	T	7.00N	3.0	1A224	Burres	OPT
6036	9.745	Gen Prin Ins \$26.25	03	M	7.00N	3.0	1A210	Briscoe	PNP
6044	9.440	Eye Care Prof Ast. \$26.25	03	M	7.00N	3.0	LRC211	Burdell	PNP
6051	9.010	Attitude Awareness	03	M	7.00N	3.0	1A224	Thornton	OPT
6141	9.005	Creative Activities \$26.25	03	M	7.00N	3.0	0207A	Scheer	OPT
6376	9.011	Attitude, Appear. and Ability/Waitress \$17.50	02	T	7.00N	3.0	ELC-C5	Miller	

CHANGES

- 2005 12:30 on Thurs. (time change)
- 2031 Medication Aide, 4 cr., \$17.50
- 2085 5.454 (course change)
- 2905 2:00, CC202E, Dallman (time, room, instructor change)
- 3385 Shanks (instructor change)
- 3695 Variable credit 1-3
- 3750 add prerequisite: MU50, MU51 or instructor permission
- 3835 McComb (instructor change)
- 4315 ST130 (room change)
- 4340 add PNP
- 4431 add PNP
- 4450 2.5 hr. (duration change)
- 5505 6 cr., Monday in LRC117, Thurs. in 1A237 (room changes)
- 5520 5 cr., Monday in 1A237, Wed. in H121 (room changes)
- 5525 5 cr., Monday in 1A237, Wed. in 1A212 (room changes)
- 6015 Sjoqren (instructor change)
- 6044 Wed., ST202 (day and room change)
- 6051 \$26.25 fee
- 6240 Henderly (instructor change)
- 6290 2.5 hr. (duration change)
- 6300 2.5 hr. (duration change)
- 6325 Walker (instructor change)
- 6335 Not OPT grading
- 6390 Not OPT grading

CANCELLED CLASSES

- 4810 6025
- 4870 6200
- 4875 6295

## TABLE OF CONTENTS

<b>RECORDS INFORMATION</b> .....	2	<b>SCIENCE &amp; TECHNOLOGY DIVISION</b> .....	19
<b>REGISTRATION INFORMATION</b> .....	3	Agriculture Technology .....	19
For 8 or more credit hours .....	3	Plant Science .....	19
For 7 or less credit hours .....	3	Animal Science .....	20
<b>MAJOR CODES</b> .....	4	Farm Management .....	20
<b>TUITION SCHEDULE</b> .....	5	Biological Sciences .....	20
<b>CREDIT CLASS SCHEDULE BEGINS</b> .....	6	Engineering Technology .....	21
 		Civil/Mechanical Technology .....	21
<b>ALLIED HEALTH AND</b>		Drafting Technology .....	21
<b>PHYSICAL EDUCATION DIVISION</b> .....	6	Electricity/Electronics Technology .....	21
Associate Degree Nursing .....	6	General Engineering .....	22
Nursing Assistant .....	6	Environmental Science Technology .....	22
Dental Assistant .....	7	Refrigeration/Heating/Air Conditioning Tech. ....	22
Physical Education .....	7	Science Laboratory Technology .....	22
Health .....	8	Water/Wastewater Technology .....	22
 		Fire Science .....	22
<b>BUSINESS &amp; INDUSTRIAL DIVISION</b> .....	8	Mathematics .....	23
Business Management .....	8	Physical Sciences .....	24
Banking and Finance .....	9	 	
Small Business Management .....	9	<b>LEARNING SERVICES DIVISION</b> .....	24
Supervisory Training .....	9	Reading .....	24
Business Skills .....	10	Study Skills .....	24
Data Processing .....	11	 	
Food Services .....	12	<b>ARMY RESERVE OFFICERS TRAINING</b> .....	25
Auto Body Repair .....	12	 	
Automotive Technology .....	12	<b>GUIDANCE SERVICES</b> .....	25
Machine Tool Technology .....	12	 	
Metallurgical Technology .....	13	<b>COOPERATIVE WORK EXPERIENCE</b> .....	25
Small Engine & Recreational Vehicle Repair .....	13	 	
Welding .....	13	<b>COMMUNITY EDUCATION DIVISION</b> .....	26
Construction Technology/Carpentry .....	14	Apprenticeship .....	26
 		Albany Center .....	26
<b>HUMANITIES &amp; SOCIAL SERVICES DIVISION</b> .....	14	Central Linn .....	27
Art .....	14	Benton Center .....	27
Criminal Justice Administration .....	15	Santiam Center .....	28
Drama-Speech .....	15	East Linn Center .....	28
English-Journalism-Foreign Language .....	15	Scio .....	28
Graphic Communications .....	17	 	
Human Services .....	17	<b>GENERAL INFORMATION</b> .....	i
Music .....	17		
Philosophy and Religion .....	18		
Social Science .....	18		
Anthropology .....	18		
Economics .....	18		
Education .....	18		
Family Living .....	18		
Geography .....	18		
History .....	18		
Political Science .....	18		
Sociology .....	19		

## RECORDS INFORMATION

Pursuant to Public Law 93-380, recently enacted Federal legislation, students may see and review all official records, files, or data pertaining to that student with the following exceptions: confidential financial information reported by the parent-guardian unless the latter has explicitly granted written permission for the student to review the financial statement, and medical, psychiatric, or similar records used for treatment purposes.

The amount of data accumulated by the College will differ for each student and would be dependent upon his or her use of the available services and the length of stay at the College.

Access to their records is guaranteed to all students as early as possible but must be within 45 days of the student's official request.

A student may challenge the content of a record that he or she considers inaccurate, misleading, or otherwise in violation of the privacy or other rights of students. If the challenge is not resolvable with the custodian of the records, the student has a right to a hearing as outlined in the Students Rights, Freedoms, Responsibilities and Due Process document.

Linn-Benton Community College considers the following to be directory information and releasable to anyone upon request: student's name, address, telephone listing, major field of study, participation in officially recognized activities and sports, weight and height of members of athletic teams, school or division of enrollment, periods of enrollment, degrees and awards received.

Students who do not wish to have any of the information listed above released by the College must complete a directory deletion form in the Registrar's Office.

Students may have records in the following offices:

1. Admissions and Registrar's Office: Custodian of records is the Director of Admissions and Registrar. Access of records is limited to college personnel.
2. Guidance Center: Custodian of records is the Director of Guidance. Access of records is limited to Guidance Services Staff.
3. Student Health Center: Custodian of records is the Health Nurse. Access of records is limited to Guidance Services Staff.
4. Dean of Students Office: Custodian of records is the Dean of Students. Access of records is limited to the Dean.
5. Financial Aids Office: Custodian of records is the Coordinator of Financial Aids. Access to records is limited to Financial Aids Staff.
6. Placement Office: Custodian of records is the Coordinator of Placement. Access to records is limited to Placement Office Staff.

Release of student information shall not be withheld from representatives of the following agencies: a) the Comptroller General of the United States, b) the Secretary, c) an administrative branch of an educational agency, d) State educational authorities, authorities who by either Federal or State law or by legislative directive have the right to audit and evaluate, e) the audit firm retained by the Linn-Benton Community College Board of Education.

All records that pertain to academic achievement, evaluative tests, and to the student's payment of tuition and fees are considered permanent records of the college. Records of health treatment or physical examinations are retained for a period of seven years. Disciplinary records are retained for one year after the student's last date of attendance except where the conditions of the disciplinary action exceed one year.

## REGISTRATION INFORMATION FOR STUDENTS TAKING 8 OR MORE CREDIT HOURS

Steps to be taken BEFORE you stand in line to register:

- 1. ADMISSION.** Students planning to enroll for 8 or more credit hours:  
File an Application for Admission  
File transcripts from previous schools attended  
Make arrangements to take the Comparative Guidance and Placement Test (CGP)
- 2. ADVISING.** New Students enrolling for 8 or more credit hours will receive advising help during the advising/registration period planned for new students. New students who have completed the admission process will be assigned a date for advising by the Admissions office. **Continuing** students may plan their own programs and register without staff approval. If assistance is necessary, contact a faculty advisor or the Guidance Center.
- 3. PROGRAM APPROVAL.** All NEW students must secure counselor approval (CC-110) or their program.
- 4. GRADUATION REQUIREMENTS.** Students expecting to receive an Associate Degree or departmental certificate from LBCC MUST apply for graduation in the Admissions and Career Information Center one term prior to graduation.
- 5. REGISTRATION.** Pick up a long-form registration packet in the registration area. Check for posted lists of filled, cancelled, added, or changed classes. Fully complete each form in ballpoint pen. Make sure all copies are legible.

**ALL CONTINUING STUDENTS IN THE FOLLOWING SPECIAL PROGRAMS** will be required to register prior to the last day of the preceding term to assure their place in the program. Space remaining in the program after the last day of the term will be opened to new students.

Auto Body Repair	Construction Technology (Carpentry)
Automotive Technology	Drafting Technology
Machine Tool Technology	Electricity/Electronics Technology
Small Engines/Recreational Vehicle Repair	Heating, Air Conditioning & Refrig. Tech.
Welding	Wastewater Technology

- 6. TUITION and FEES.** Full tuition payment is usually necessary at the time of registration. Insurance premiums should also be paid if insurance is desired.

Students sponsored by a special program or attending under a grant or scholarship must pick up an authorization at the Financial Aids Office BEFORE REGISTERING.

The Deferred Payment Plan may be used by full-time students (12 or more credit hours). One third of the tuition is paid at the time of registration and the balance by the end of the fifth week of class. Application for this plan must be made at the Financial Aids Office (CC-107) BEFORE REGISTERING, and a Deferred Payment Agreement must be presented at the time of registration.

- 7. VETERAN'S BENEFITS and SPECIAL PROGRAMS.** Students receiving benefits (G.I. Bill, Veteran's Vocational Rehabilitation, Veteran's Dependent, or Social Security) have the responsibility of starting the necessary paper work each term in order to receive these benefits. Complete the form in the registration packet and carefully follow the printed instructions. Contact the Veteran's Clerk in the Veteran's Office CC-121 if you have questions.

## REGISTRATION INFORMATION FOR STUDENTS TAKING 7 OR LESS CREDIT HOURS

Register during the pre-registration period or during the first three weeks of classes.

Enrolling in day classes the second week requires the instructor's written permission.

Enrolling the third week in any class requires the instructor's written permission and a \$1.00 late fee.

Steps to be taken BEFORE you stand in line to register:

- 1. ADMISSION.** There are no admission requirements for students taking 7 or fewer credit hours.
- 2. PROGRAM APPROVAL.** Counselor approval is not required. However, counselors are available to assist students if desired.
- 3. REGISTRATION.** Pick up a short-form registration packet in the registration area. Check for posted lists of filled, cancelled, added, or changed classes. Fully complete each form in ballpoint pen. Make sure all copies are legible.
- 4. TUITION and FEES.** Full tuition must be paid at the time of registration.
- 5. VETERAN'S BENEFITS and SPECIAL PROGRAMS.** Students receiving benefits (G.I. Bill, Veteran's Vocational Rehabilitation, Veteran's Dependent, or Social Security) have the responsibility of starting the necessary paper work each term in order to receive these benefits. Complete the form in the registration packet and carefully follow the printed instructions. Contact the Veteran's Clerk in the Veteran's Office CC-121 if you have any questions.



USE CODE NUMBER FROM THIS LIST OF MAJORS TO COMPLETE BOX ON REGISTRATION FORM

SELECT ONE OF THE FOLLOWING

PLEASE CIRCLE THE ONE NUMBER WHICH IS YOUR FIRST CHOICE OF MAJOR

- OCCUPATIONAL - TECHNICAL PROGRAMS**
- 5002 ACCOUNTING TECHNOLOGY
  - 5005 ADMINISTRATIVE SECRETARY
  - 5402 AGRICULTURE
  - 5206 ANIMAL TECHNOLOGY
  - 5600 ASSOCIATE IN GENERAL STUDIES
  - \*5208 ASSOCIATE DEGREE NURSING (RN)
  - \*5380 AUTO BODY REPAIR
  - \*5306 AUTOMOTIVE TECHNOLOGY
  - 5003 BANKING & FINANCE
  - 5598 CHILD DEVELOPMENT (1 YEAR)
  - \*5318 CONSTRUCTION TECHNOLOGY (CARPENTRY)
  - 5006 COSMETOLOGY
  - \*5320 CRAFTS & TRADES (APPRENTICE OR JOURNEYMAN)
  - 5505 CRIMINAL JUSTICE-CORRECTIONS
  - 5597 CRIMINAL JUSTICE-LAW ENFORCEMENT
  - 5101 DATA PROCESSING
  - \*5202 DENTAL ASSISTANT (1 YEAR)
  - \*5304 DRAFTING TECHNOLOGY
  - \*5310 ELECTRICITY/ELECTRONICS
  - 5098 EDUCATIONAL SECRETARY
  - 5301 ENGINEERING TECHNOLOGY
  - 5507 FIRE SCIENCE
  - 5404 FOOD SERVICES
  - 5095 GENERAL BUSINESS (1 YEAR)
  - 5012 GRAPHIC COMMUNICATIONS-COMMERCIAL ART
  - 5315 GRAPHIC COMMUNICATIONS-PRODUCTION TECHNOLOGY
  - 5405 HOME ECONOMICS
  - 5599 HUMAN SERVICES
  - 5097 LEGAL SECRETARY
  - \*5303 MACHINE TOOL TECHNOLOGY
  - 5001 MANAGEMENT
  - 5096 MARKETING
  - 5214 MEDICAL OFFICE ASSISTANT
  - 5099 MEDICAL RECEPTIONIST
  - 5213 MEDICAL TRANSCRIPTIONIST (1 YEAR)
  - 5399 METALLURGICAL TECHNOLOGY
  - \*5209 NURSING ASSISTANT
  - \*5317 REFRIGERATION, AIR CONDITIONING & HEATING
  - 5205 SCIENCE LAB TECHNICIAN
  - 5093 SECRETARIAL SERVICES (1 YEAR)
  - \*5381 SMALL ENGINE RECREATION VEHICLE REPAIR
  - 5004 SUPERVISORY TRAINING
  - 5408 WASTEWATER TECHNOLOGY
  - \*5308 WELDING
  - 5207 X-RAY TECHNICIAN
  - 5630 UNDECIDED (OCCUPATIONAL-TECHNICAL PROGRAM)
  - 5640 NONE (FOR THE USE OF STUDENTS TAKING 7 OR FEWER CREDITS ONLY)
  - 5650 ADULT EDUCATION (HIGH SCHOOL COMPLETION)

- LOWER DIVISION TRANSFER PROGRAMS**
- 0502 ACCOUNTING
  - 0101 AGRICULTURE
  - 2202 ANTHROPOLOGY
  - 0200 ARCHITECTURE
  - 1002 ART
  - 0401 BIOLOGY
  - 0506 BUSINESS ADMINISTRATION
  - 0838 BUSINESS EDUCATION
  - 1905 CHEMISTRY
  - 1507 CREATIVE WRITING
  - 2209 CRIMINAL JUSTICE ADMINISTRATION
  - 1007 DRAMA
  - 2204 ECONOMICS
  - 0802 ELEMENTARY EDUCATION
  - 0901 ENGINEERING
  - 1501 ENGLISH
  - 0418 FISHERIES BIOLOGY
  - 1101 FOREIGN LANGUAGES
  - 0114 FORESTRY
  - 1901 GENERAL SCIENCE
  - 2206 GEOGRAPHY
  - 2205 HISTORY
  - 1301 HOME ECONOMICS
  - 0602 JOURNALISM
  - 1701 MATHEMATICS
  - 1005 MUSIC
  - 0514 OFFICE ADMINISTRATION
  - 1509 PHILOSOPHY AND RELIGION
  - 0835 PHYSICAL EDUCATION & HEALTH
  - 1902 PHYSICS
  - 2207 POLITICAL SCIENCE
  - 1204 PRE-DENTAL
  - 1206 PRE-MEDICAL
  - 1203 PRE-NURSING
  - 1218 PRE-VETERINARY MEDICINE
  - 2001 PSYCHOLOGY
  - 0803 SECONDARY EDUCATION
  - 2208 SOCIOLOGY
  - 1506 SPEECH
  - 0107 WILDLIFE
  - 4901 BASIC TRANSFER PROGRAM
  - 4950 UNDECIDED (LOWER DIVISION)
  - 4960 NONE (FOR THE USE OF STUDENTS TAKING 7 OR FEWER CREDITS ONLY)

NOTE: Programs marked with \* have special admission requirements. Admission for entry into these programs must be arranged far in advance in the Admissions office. See catalog for details or contact the Admissions office at 928-2361.

Linn-Benton Community College provides access to learning for all applicants without regard to race, color, religion, sex, marital status or national origin in compliance with state and federal law.

1	2	3	4	5	6	
PLEASE DO NOT WRITE ABOVE THIS LINE						
OFFICIAL USE ONLY		L.B.C.C. REGISTRATION - 8 OR MORE CREDITS				
<input type="checkbox"/> Res. <input type="checkbox"/> Non-Res. <input type="checkbox"/> Out-St. <input type="checkbox"/> Cash <input type="checkbox"/> Check <input type="checkbox"/> Charge		DATE _____ QTR _____ Name <b>SMITH</b> <b>MARY</b> <b>P</b> <b>926-8111</b> Address <b>1234 MAIN ST</b> <b>ALBANY</b> <b>OR</b> <b>97321</b> MAJOR CODE <b>0506</b> (See Schedule) SOCIAL SECURITY No. <b>123</b> <b>456789</b> State <b>OR</b> FROSH <input type="checkbox"/> SOPH <input type="checkbox"/>		Tuition _____ Fees _____ Late Fee _____ Total _____ Ins. _____		Initial _____ Phone _____ Zip _____
TERM LINE NUMBER	COURSE NO.	COURSE NAME	CR	M	BLDG. RM. INSTRUCTOR	
2280	BLK 1	TYPING-TRANSFER	2		B209 STAFF	
2445	BA 101	INTRO TO BUS.	1/3	1/3	B 104 STAFF	
3210	1.101	COMM SKILLS	1/10		LAC 211 SWEET	
2170	PE 185	ADV BOWLING	1	8/9:30	LL IRVIN	
3800	MT 100	INT ALGEBRA	4	10	10 ST 119 REED	
3810		LAB 2	11	11	LRC 202	
3450	PSY 202	GEN PSYCH	3	1	1 0205A MONTGOMERY	

## CLASS LOCATION KEY

AC .....	Activities Center, LBCC Campus
AFS .....	Albany Fire Station, Albany
B .....	Business Education Building, LBCC Campus
BC .....	Benton Center, 1235 NW Pierce Way, Corvallis
CC .....	College Center Building, LBCC Campus
CHS .....	Corvallis High School, Corvallis
CLHS .....	Central Linn High School, Halsey
CVHS .....	Crescent Valley High School, Corvallis
CWC .....	Corvallis Woman's Club, Corvallis
F .....	Forum Building, LBCC Campus
FCC .....	First Christian Church, Corvallis
H .....	Humanities Building, LBCC Campus
IA .....	Industrial Building A, LBCC Campus
IB .....	Industrial Building B, LBCC Campus
JANZ BLDG .....	Jantz Building, Scio
LHS .....	Lebanon Union High School, Lebanon
LL .....	Lakeshore Lanes, 682 Airport Rd., Albany
LRC .....	Learning Resource Center, LBCC Campus
O .....	Occupational Services Bldg., LBCC Campus
PHS .....	Philomath High School, Philomath
SHHS .....	Sweet Home High School, Sweet Home
ST .....	Science-Technology Bldg., LBCC Campus
TBA .....	To be Arranged
TELL SELL .....	Tell & Sell Printing, Sweet Home
TC .....	Tennis Court, LBCC Campus
YMCA .....	Mid-Willamette Valley YMCA, Albany

### TUITION AND FEES SUBJECT TO CHANGE

	<u>Resident</u>	<u>Non-Resident</u>	<u>Out-of-State</u>
Per Credit Hour	\$ 8.75	\$16.00	\$43.00
Minimum Charge	17.50	32.00	43.00
Full-time (12 or more credit hrs.)	105.00	192.00	516.00
*Per Credit Hr. over 20	8.75	16.00	43.00
*Non Refundable			

Late Registration Fee:

8 or more credit hours - \$2 per day beginning first day of classes  
 7 or less credit hours ----- \$1 during third week

Add Fee:

First change of schedule involving one or more added classes ----- No Charge  
 Subsequent changes of schedule involving one or more added classes ----- each change, \$2.00

Drop Fee: ----- No Charge

Credit by Examination ----- \$8.75 per Credit Hour

Transcript Fee:

Official Copy ----- \$1.50 per copy including first copy  
 Student ----- \$ .50 per copy

BankAmericard and Master Charge are accepted for tuition, fees and Bookstore expenses.

SCHEDULE KEY

- ① PREREQUISITE - P (See catalog for prerequisite)
- ② TERM LINE NUMBER - Identifies individual sections  
Boxed numbers 6250 indicate course appears elsewhere in schedule
- ③ CREDITS given for course
- ④ DAYS OF CLASS MEETINGS: M-Monday, T-Tuesday, W-Wednesday, H-Thursday, F-Friday
- ⑤ STARTING TIME of class - All times shown are daytime unless next column shows "N"
- ⑥ NIGHT CLASS - N
- ⑦ DURATION - Length in hours of each class session
- ⑧ LOCATION and ROOM - See Class Location Key and Campus Map inside front cover
- ⑨ PASS/NO PASS - PNP indicates class is given only on pass/no pass basis  
OPT indicates student has the option of pass/no pass or letter grading - See Pass/No Pass Instruction at back of schedule

①	②					③	④	⑤	⑥	⑦			⑧	⑨
P	TLN	COURSE NUMBER	COURSE TITLE	CR	MTWHF	START TIME	N	DUR	RM LOC	RM	INSTRUCTOR	P/NP		

**ALLIED HEALTH and PHYSICAL EDUCATION DIVISION**

ASSOCIATE DEGREE NURSING  
Special Admission Procedure for Curriculum Classes

CURRICULUM CLASSES												
	2005	5.711	NURSING I LECTURE	05	MT	9.00		1	U 114		WOOD/PAULSON	
			LAB		H	12:30		1	O 114		WOOD/PAULSON	
					WHF	7.00		3	O 114		WOOD/PAULSON	
P	2010	5.721	NURSING IV LECTUR	09	MT	8.00		2	O 116		MCCRAW/PRSTN	
			LAB		WHF	7.00		5	U 116		MCCRAW/PRSTN	
P	2015	5.726	NURS CONT SOC	01	M	11.00		1	U 114		STAFF	
NON-CURRICULUM CLASSES												
	2020	5.630	ANATOMICAL TERM	03	T-H	8.00		1.5	O 202		FORNELLI,L	
	2030	9.405	MED ASST I	03	T	7.00	N	3	U 114		STAFF	
	2035	9.421	MED TERMIN	03	W	7.00	N	3	O 114		STAFF	
	2040	9.427	CONT ED/NURSES	01		TBA					STAFF	

NURSING ASSISTANT  
Special Admission Procedure

	2045	5.406	NURS ASST LEC	05	MTWHF	11.00		1	U 116		MILLS,A	
					MTWHF	1.00		1	U 116		MILLS,A	
	2050	5.407	NURSING ASST LAB	07	MTWHF	8.00		3	O 113		MILLS,A	
	2055	5.400	NURSING HM ASST	03		TBA			U 113		FORNELLI,L	
			60 HOUR COURSE TAUGHT INTERMITTENTLY FALL TERM									

P	COURSE		START				RM		INSTRUCTOR	P/NP
	TLN	COURSE TITLE	CR	MTWHF	TIME	N	DUR	LOC		
DENTAL ASSISTANT Special Admission Procedure										
2060	5.494	CLIN PRACT I LAB	04	T F TW	9.00 2.00	2	2	U 213	MORGAN,G	
P 2065	5.461	DNTL RAD II	02	M	9.00	2	U 213	ARTHUR,J		
2070	5.484	DENT MAT LAB I	02	M W	1.00	2	U 213	MORGAN,G		
P 2075	5.510	OFFICE PRACTICUM	08	MTW	8.00	8	U 209	MORGAN,G		
P 2080	5.515	OFFICE PRACT SEM	03	H	1.00	3	U 209	MORGAN,G		
2085	5.454	PATIENT ED	02		TBA	2		STAFF		
2090	9.317	FIRST AID MM	01		TBA			STAFF		
PHYSICAL EDUCATION										
2095	PE180	BASKETBALL WOMEN'S RULES + OR	01	T-H EXERCISES	9.30	1.5	AC 159E	STAFF		OPT
2100	PE180	BODY COND WOMEN'S RULES + OR	01	M W F EXERCISES	12.00	1	AC 120	STAFF		OPT
2105	PE180	BODY COND WOMEN'S RULES + OR	01	M W F EXERCISES	8.00	1	AC 120	STAFF		OPT
2110	PE180	VOLLEYBALL WOMEN'S RULES + OR	01	T-H EXERCISES	11.00	1.5	AC 159E	IRVIN,J		OPT
P 2115	PE180	INT GYMNASTICS WOMEN'S RULES + OR	01	M W F EXERCISES	3.00	1	AC 159W	CROSMAN,A		OPT
2120	PE180	BEG GYMNASTICS WOMEN'S RULES + OR	01	T-H EXERCISES	1.00	1.5	AC 159W	CROSMAN,A		OPT
2125	PE185	CROSS COUNTRY	01	M W F	3.00	1	AC	BAKLEY,D		OPT
P 2130	PE185	INT SWIMMING	01	M W F	10.00	1	YMCA	CROSMAN,A		OPT
P 2135	PE185	ADV SWIMMING	01	M W F	10.00	1	YMCA	CROSMAN,A		OPT
2140	PE185	BEG SWIMMING	01	M W F	11.00	1	YMCA	CROSMAN,A		OPT
P 2145	PE185	INT SWIMMING	01	M W F	2.00	1	YMCA	CROSMAN,A		OPT
P 2150	PE185	ADV SWIMMING	01	M W F	2.00	1	YMCA	CROSMAN,A		OPT
2155	PE185	BEG TENNIS	01	M W F	1.00	1	TC	KIMPTON,V		OPT
P 2160	PE185	INT TENNIS	01	T-H	9.30	1.5	TC	KIMPTON,V		OPT
P 2165	PE185	INT TENNIS	01	T-H	1.00	1.5	TC	KIMPTON,V		OPT
P 2170	PE185	ADV TENNIS	01	T-H	1.00	1.5	TC	KIMPTON,V		OPT
P 2175	PE185	INT TENNIS	01	T-H	11.00	1.5	TC	CROSMAN,A		OPT
2180	PE185	BEG TENNIS	01	M W F	4.00	1	TC	STAFF		OPT
FOR GOLF CLASSES, STUDENTS WILL BE REQUIRED TO PAY FOR RANGE BALLS.										
2185	PE185	BEG GOLF	01	T-H	9.00	1.5	TC	STAFF		OPT
P 2190	PE185	INT GOLF	01	T-H	10.30	1.5	TC	STAFF		OPT
P 2195	PE185	ADV GOLF	01	W F	12.00	1.5	SH	DENHAM,R		OPT
FOR BOWLING CLASSES, STUDENTS WILL BE REQUIRED TO PAY \$9.00 LINEAGE FEE TO THE BOWLING ALLEY										
2200	PE185	BEG BOWLING	01	M W F	8.00	1	LL	NYQUIST,D		OPT
P 2205	PE185	INT BOWLING	01	T-H	8.00	1.5	LL	NYQUIST,D		OPT
P 2210	PE185	INT BOWLING	01	M W F	3.00	1	LL	NYQUIST,D		OPT
P 2215	PE185	ADV BOWLING	01	M W F	3.00	1	LL	NYQUIST,D		OPT

P	TLN	COURSE		START			RM		INSTRUCTOR	P/NP	
		NUMBER	COURSE TITLE	CR	MTWHF	TIME	N	DUR			LOC
	2220	PE185	BICYCLING	01	M W F	3.00	1	AC		STAFF	OPT
	2225	PE185	JOGGING	01	M W F	12.00	1	AC		STAFF	OPT
	2230	PE185	JUDO	01	W	7.00	N 3	AC	120	STAFF	OPT
	2235	PE185	KARATE	01	T F	7.00	N 1.5	AC	159E	STAFF	OPT
	2240	PE185	BADMINTON	01	M W F	9.00	1	AC	159E	STAFF	OPT
	6225	PE185	BALLET, BEG								
P	6230	PE185	BALLET, ADV								
			SEE BENTON CENTER LISTING FOR THESE TLN'S								
	2245	PE190	FLAG FOOTBALL MEN'S RULES + OR EXERCISES	01	T-H	1.00	1.5	AC		STAFF	OPT
	2250	PE190	BEG BASEBALL MEN'S RULES + OR EXERCISES CLASS LASTS 3 WEEKS	01	MTWHF	3.00	2	AC		MCCLAIN,R	OPT
	2255	PE190	BODY COND MEN'S RULES + OR EXERCISES	01	M W F	9.00	1	AC	120	STAFF	OPT
	2260	PE190	BODY COND MEN'S RULES + OR EXERCISES	01	M W F	2.00	1	AC	120	STAFF	OPT
	2265	PE190	BASKET COND MEN'S RULES + OR EXERCISES BEGINS FIRST DAY OF CLASS-LASTS 3 WEEKS INSTRUCTOR APPROVAL	01	MTWHF	2.00	2	AC	159E	KIMPTON,V	OPT
P	2270	PE190	ADV BASKETBALL MEN'S RULES + OR EXERCISES STARTS OCT. INSTRUCTOR APPROVAL	01	MTWHF	3.00	1	AC	159E	KIMPTON,V	OPT
	2275	PE194	PROF ACT-BAD-TENN	02	M W F	10.00	2	AC	159E	IRVIN,J	OPT
	2280	PE232	ORIENT/BACK PACKG	03	M W F	3.00	1	AC	127	STAFF	OPT
			HEALTH								
	2285	9.317	M-M FIRST AID	01		TBA				STAFF	OPT
	2290	HE250	PERSONAL HEALTH	03	M W F	11.00	1	AC	127	STAFF	OPT
	2295	HE250	PERSONAL HEALTH	03	T-H	8.00	1.5	AC	127	IRVIN,J	OPT
	2300	HE250	PERSONAL HEALTH	03	M W F	2.00	1	AC	127	STAFF	OPT
	2305	HE250	PERSONAL HEALTH	03	T-H	1.00	1.5	AC	127	IRVIN,J	OPT
	2310	HE250	PERSONAL HEALTH	03	W	7.00	N 3	AC	127	STAFF	OPT
	2315	HE252	FIRST AID	03	M	7.00	N 3	AC	127	BAKLEY,D	OPT
	2320	HE252	FIRST AID	03	T-H	9.30	1.5	AC	127	BAKLEY,D	OPT
	2325	HE252	FIRST AID	03	M W F	4.00	1	AC	127	STAFF	OPT
	2330	4.108	IND. SAFETY	03	F	8.00	3	AC	127	BAKLEY,D	OPT

## BUSINESS and INDUSTRIAL DIVISION

### BUSINESS MANAGEMENT

	2335	2.500	BUS ORIENTATION THIS COURSE REQUIRED FOR ALL FIRST TERM BUSINESS STUDENTS	01	T	2.00	2	F	104	LEDBETTER,W	PNP
	2340	2.540	LEADERSHIP-DECA	01		TBA				STAFF	PNP
	2345	BA101	INTRO TO BUSINESS	04	T-H	9.30	2	F	115	CONNERS,G	
	2350	BA101	INTRO TO BUSINESS	04	M W	1.00	2	F	113	LAWRENCE,D	
	2355	BA101	INTRO TO BUSINESS	04	H	6.30	N 4	F	204	STAFF	

P	TLN	COURSE		START			RM		INSTRUCTOR	P/NP
		NUMBER	COURSE TITLE	CR	MTWTF	TIME	N	DUR		
	2360	BA211	PRIN OF ACCT I	03	M W F	10.00	1	F 113	CHAMBERS,M	
	2365	BA211	PRIN OF ACCT I	03	M W F	1.00	1	F 115	CHAMBERS,M	
	2370	BA211	PRIN OF ACCT I	03	W	7.00	N 3	F 115	CHAMBERS,M	
	2375	BA226	BUSINESS LAW	03	T	7.00	N 3	F 115	STAFF	
	2380	2.530	PRACTICAL ACCT I	03	MTWTF	9.00	1	B 201	LEDBETTER,W	
	2385	2.530	PRACTICAL ACCT I	03	MTWTF	10.00	1	B 201	LEDBETTER,W	
	2390	2.530	PRACTICAL ACCT I	03	MTWTF	12.00	1	B 201	ATWOOD,I	
	2395	2.530	PRACTICAL ACCT I	03	MTWTF	1.00	1	B 201	WALCZAK,A	
	2400	2.530	PRACTICAL ACCT I LAB	03	T	7.00	N 3	B 201	LEDBETTER,W	
					H	7.00	N 2	B 201	LEDBETTER,W	
	<u>6355</u>	2.530	PRACT ACCT I	SEE EAST LINN CENTER LISTING FOR THIS TLN						
P	2405	2.531	PRACTICAL ACCT II	03	MTWTF	1.00	1	B 101	LEDBETTER,W	
P	2410	2.595	INTERMED ACCT I	03	M W F	11.00	1	B 118	CHAMBERS,M	
P	2415	2.595	INTERMED ACCT I	03	T	7.00	N 3	B 118	CHAMBERS,M	
	2420	9.743	INCOME TAX PREP	03	M W F	9.00	1	B 118	CHAMBERS,M	OPT
	2425	9.743	INCOME TAX PREP	03	T	7.00	N 3	LRC 209	POUND,J	OPT
	2430	2.125	INCOME TAX PREP	06	T-H	7.00	N 3	F 113	ALLEN,D	
	2435	2.131	MARKETING	03	T-H	9.30	1.5	B 107	STAFF	
	2440	2.110	SALESMANSHIP	03	W	7.00	N 3	B 118	STAFF	
	2445	2.518	BUSINESS LAW	03	M W F	12.00	1	B 107	LEDBETTER,W	
	2450	2.119	INTRO TO MNGT	03	T-H	1.00	1.5	B 104	CONNERS,G	
	2455	2.645	BUS CONF TECH	03	M W F	10.00	1	B 107	CONNERS,G	
	2460	2.420	HUMAN RELATIONS- YOUR ATTITUDE IS SHOWING I	03	H	7.00	N 3	B 107	MOVIUS,E	OPT
	2465	2.421	HUMAN RELATIONS- YOUR ATTITUDE IS SHOWING II	03	W	7.00	N 3	B 107	MOVIUS,E	OPT
	2470	2.415	HUMAN REL IN BUS	03	M W F	2.00	1	B 107	MOVIUS,E	
P	2475	2.710	ON JOB TRAIN-MNGT 3-12 CREDITS - REQUIRES PERMISSION OF INSTRUCTOR	12	W	6.00	N 1	B 107	STAFF	OPT
	<u>3840</u>	EC201	PRIN OF ECONOMICS	03	M W F	9.00	1	F 115	CONNERS,G	
	<u>3845</u>	EC201	PRIN OF ECONOMICS	03	H	7.00	N 3	F 115	CONNERS,G	
			Banking & Finance							
	2480	2.153	LAW + BANKING	03	T	7.00	N 3	H 220	STAFF	
	2485	2.150	PRIN OF BANK OPER	03	W	7.00	N 3	F 204	STAFF	
	2490	2.164	Installment Credit	03	H	7.00	N 3	H 220	STAFF	
			Small Business Management							
	2495	9.250	SMALL BUS MNGT I	03	W	7.00	N 3	F 113	STAFF	OPT
			Supervisory Training							
	2500	9.500	ELEM SUPERVISION	03	T	7.00	N 3	B 107	CONNERS,G	
	<u>6200</u>	9.500	ELEM /SUPERVISION	SEE BENTON CENTER LISTING FOR THIS TLN						
	2505	9.514	COST CONTROL	03	W	7.00	N 3	B 101	STAFF	
	2510	9.555	IND SAFETY I	03	H	7.00	N 3	B 101	SHEPHERD,R	

P	TLN	COURSE NUMBER	COURSE TITLE	START			RM LOC	RM	INSTRUCTOR	P/NP
				CR	MTWHF	TIME				
BUSINESS SKILLS										
TYPING BLOCKS										
TRANSFER BLOCK CONSISTS OF TYPING I, II, III AND SKILL BUILDING										
VOCATIONAL BLOCK CONSISTS OF TYPING I, II, III, IV, SKILL BUILDING AND MEDICAL TYPING										
STUDENTS MAY BEGIN AT ANY TIME AND ADVANCE AT THEIR OWN RATE										
	2515	T TB1	TYPING-TRANSFER	03	MTWHF	8.00	1	B 209	BROOKS,G	
	2520	V.TB1	TYPING-VOCATIONAL	03	MTWHF	8.00	1	B 209	BROOKS,G	
	2525	T TB2	TYPING-TRANSFER	03	MTWHF	9.00	1	B 209	LAWRENCE,D	
	2530	V.TB2	TYPING-VOCATIONAL	03	MTWHF	9.00	1	B 209	LAWRENCE,D	
	2535	T TB3	TYPING-TRANSFER	03	MTWHF	10.00	1	B 209	MOREIRA,J	
	2540	V.TB3	TYPING-VOCATIONAL	03	MTWHF	10.00	1	B 209	MOREIRA,J	
	2545	T TB4	TYPING-TRANSFER	03	MTWHF	11.00	1	B 209	MOREIRA,J	
	2550	V.TB4	TYPING-VOCATIONAL	03	MTWHF	11.00	1	B 209	MOREIRA,J	
	2555	T TB5	TYPING-TRANSFER	03	MTWHF	12.00	1	B 209	HAZEL,D	
	2560	V.TB5	TYPING-VOCATIONAL	03	MTWHF	12.00	1	B 209	HAZEL,D	
	2565	T TB6	TYPING-TRANSFER	03	MTWHF	1.00	1	B 209	HAZEL,D	
	2570	V.TB6	TYPING-VOCATIONAL	03	MTWHF	1.00	1	B 209	HAZEL,D	
	2575	T TB7	TYPING-TRANSFER	03	MTWHF	2.00	1	B 209	ATWOOD,I	
	2580	V.TB7	TYPING-VOCATIONAL	03	MTWHF	2.00	1	B 209	ATWOOD,I	
	2585	T TB8	TYPING-TRANSFER	03	MTWHF	3.00	1	B 209	STAFF	
	2590	V.TB8	TYPING-VOCATIONAL	03	MTWHF	3.00	1	B 209	STAFF	
	2595	T TB9	TYPING-TRANSFER	03	M W	7.00	N 2.5	B 209	BROOKS,G	
	2600	V.TB9	TYPING-VOCATIONAL	03	M W	7.00	N 2.5	B 209	BROOKS,G	
P	6170	2.505	TYPING SKL BLDG							
P	6175	SS124	TYPING SKL BLDG							
SEE BENTON CENTER LISTING FOR THESE TLN'S										
MATH/MACHINES BLOCK										
THE BLOCK INCLUDES BUSINESS MATH, OFFICE MACHINES AND ADVANCED OFFICE MACHINES										
COURSES ARE TAKEN ONE AT A TIME										
STUDENTS MAY BEGIN AT ANY TIME AND ADVANCE AT THEIR OWN RATE										
	2605	2.515	BUSINESS MATH	03	MTWHF	8.00	1	B 211	WALCZAK,A	
	2610	2.521	OFFICE MACHINES	03	MTWHF	8.00	1	B 211	WALCZAK,A	
P	2615	2.522	ADV OFF MACHINES	03	MTWHF	8.00	1	B 211	WALCZAK,A	
	2620	2.515	BUSINESS MATH	03	MTWHF	9.00	1	B 211	WALCZAK,A	
	2625	2.521	OFFICE MACHINES	03	MTWHF	9.00	1	B 211	WALCZAK,A	
P	2630	2.522	ADV OFF MACHINES	03	MTWHF	9.00	1	B 211	WALCZAK,A	
	2635	2.515	BUSINESS MATH	03	MTWHF	10.00	1	B 211	CHESTER,P	
	2640	2.521	OFFICE MACHINES	03	MTWHF	10.00	1	B 211	CHESTER,P	
P	2645	2.522	ADV OFF MACHINES	03	MTWHF	10.00	1	B 211	CHESTER,P	
	2650	2.515	BUSINESS MATH	03	MTWHF	11.00	1	B 211	CHESTER,P	
	2655	2.521	OFFICE MACHINES	03	MTWHF	11.00	1	B 211	CHESTER,P	
P	2660	2.522	ADV OFF MACHINES	03	MTWHF	11.00	1	B 211	CHESTER,P	
	2665	2.515	BUSINESS MATH	03	MTWHF	12.00	1	B 211	BROOKS,G	
	2670	2.521	OFFICE MACHINES	03	MTWHF	12.00	1	B 211	BROOKS,G	
P	2675	2.522	ADV OFF MACHINES	03	MTWHF	12.00	1	B 211	BROOKS,G	
	2680	2.515	BUSINESS MATH	03	MTWHF	1.00	1	B 211	BROOKS,G	
	2685	2.521	OFFICE MACHINES	03	MTWHF	1.00	1	B 211	BROOKS,G	
P	2690	2.522	ADV OFF MACHINES	03	MTWHF	1.00	1	B 211	BROOKS,G	
	2695	2.515	BUSINESS MATH	03	MTWHF	2.00	1	B 211	HAZEL,D	
	2700	2.521	OFFICE MACHINES	03	MTWHF	2.00	1	B 211	HAZEL,D	
P	2705	2.522	ADV OFF MACHINES	03	MTWHF	2.00	1	B 211	HAZEL,D	
P	2710	SS112	STENO II	03	MTWHF	2.00	1	B 203	CHESTER,P	
P	2715	2.542	STENO II	03	MTWHF	2.00	1	B 203	CHESTER,P	
P	2720	SS113	STENO III	03	MTWHF	2.00	1	B 203	CHESTER,P	
P	2725	2.543	STENO III	03	MTWHF	2.00	1	B 203	CHESTER,P	

P	TLN	COURSE NUMBER	COURSE TITLE	START			RM		INSTRUCTOR	P/NP	
				CR	MTWHF	TIME	N	DUR			LOC
	2730	SS111	STENO I	03	T-H	7.00	N	2.5	B 203	HAZEL,D	
	2735	2.541	STENO I	03	T-H	7.00	N	2.5	B 203	HAZEL,D	
P	2740	SS112	STENO II	03	T-H	7.00	N	2.5	B 203	HAZEL,D	
P	2745	2.542	STENO II	03	T-H	7.00	N	2.5	B 203	HAZEL,D	
P	2750	SS113	STENO III	03	T-H	7.00	N	2.5	B 203	HAZEL,D	
P	2755	2.543	STENO III	03	T-H	7.00	N	2.5	B 203	HAZEL,D	
	2760	SS111	STENO I	03	MTWHF	11.00		1	B 203	LAWRENCE,O	
	2765	2.541	STENO I	03	MTWHF	11.00		1	B 203	LAWRENCE,O	
	2770	SS111	STENO I	03	MTWHF	1.00		1	B 203	ATWOOD,I	
	2775	2.541	STENO I	03	MTWHF	1.00		1	B 203	ATWOOD,I	
	6180	2.541	SHORTHAND I								
	6185	SS111	SHORTHAND I								
P	6190	2.542	SHORTHAND II								
P	6195	SS112	SHORTHAND II								
SEE RENTON CENTER LISTING FOR THESE TLN'S											
	6290	2.541	STENO I								
P	6300	2.542	STENO II								
SEE SANTIAM CENTER LISTING FOR THESE TLN'S											
P	2780	SS211	APPLIED STENO I	03	M W F	9.00		2	B 203	ATWOOD,I	
P	2785	2.545	APPLIED STENO I	03	M W F	9.00		2	B 203	ATWOOD,I	
P	2790	SS212	APPLIED STENO II	03	M W F	9.00		2	B 203	ATWOOD,I	
P	2795	2.546	APPLIED STENO II	03	M W F	9.00		2	B 203	ATWOOD,I	
P	2800	SS213	APPLIED STENO III	03	M W F	9.00		2	B 203	ATWOOD,I	
P	2805	2.547	APPLIED STENO III	03	M W F	9.00		2	B 203	ATWOOD,I	
	2810	2.590	READ/CONF SEC	05	MTWHF	TBA				CHESTER,P	
VARIABLE CREDITS 1-5 CREDITS											
	2814	2.652	FILING	01	T-H	9.00		1	B 203	CHESTER,P	
	2815	2.652	FILING	01	T-H	10.00		1	B 203	WALCZAK,A	
P	2820	2.539	LEADERSHIP-FSA	01	H	2.00		2	B 118	LAWRENCE,O	PNP
P	2825	2.615	ON JOB TRAIN-SEC	12		TBA				LAWRENCE,O	
3-12 CREDITS, REQUIRES INSTRUCTOR PERMISSION											
P	2830	2.527	TRANS. MACHINES I	03	MTWHF	TBA				CHESTER,P	
P	2835	2.507	EXECUTIVE TYPE	01	MTWHF	TBA				CHESTER,P	
P	2840	2.524	MED TRANSCRIPT I	03	MTWHF	TBA				LAWRENCE,O	
P	2845	2.525	MED TRANSCRIPT II	03	MTWHF	TBA				LAWRENCE,O	
	6350	9.739	OFFICE PROCEDURES								
SEE EAST LINN CENTER LISTING FOR THIS TLN											
DATA PROCESSING											
P	2850	BA131	INTRO DATA PROC	04	T-H	1.00		1.5	B 107	STAFF	OPT
LAB TBA 3											
**FORTRAN PROGRAMMING**											
	2855	2.508	INTRO KEYPUNCH OP	02		TBA		5		MOREIRA,J	OPT
P	2860	2.556	ADV KEYPUNCH OP	03		TBA		7.5		MOREIRA,J	OPT
	6295	2.509	INTRO COMPUTERS								
SEE SANTIAM CENTER LISTING FOR THIS TLN											
	2865	2.510	INTRO TO DATA PRO	04	M W F	1.00		1	B 118	STAFF	OPT
LAB F TBA 2											
	2870	2.558	INTRO TO PROGMNG	04	T-H	1.00		1.5	B 107	STAFF	OPT
LAB TBA 3											
** FORTRAN PROGRAMMING **											



P	TLN	COURSE		CR	MTWHF	START		N	DUR	RM		INSTRUCTOR	P/NP
		NUMBER	COURSE TITLE			TIME				LOC	RM		
	2875	2.571	DATA PROC I	10	MTWHF	8.00		4		B 104		STAFF	
P	2860	2.561	DATA PROC IV	10	MTWHF	8.00		4		B 104		STAFF	
FOOD SERVICES													
	2885	8.303	INTRO PRO COOKING	10	MTWHF	9.00		4		CC 202		DALLMANN,C	
P	2890	8.304	INTERMED COOK I	10	MTWHF	9.00		4		CC 202		DALLMANN,C	
P	2895	8.305	INTERMED COOK II	10	MTWHF	9.00		4		CC 202		DALLMANN,C	
P	2900	8.306	ADV PRO COOK I	10	MTWHF	9.00		4		CC 202		DALLMANN,C	
	2905	8.311	A COOK'S FRENCH	03	H	1.00		3		LRC 207		STAFF	OPT
	2910	8.315	INTRO KIT PROD/MG	10	MTWHF	9.00		4		CC 202		DALLMANN,C	
P	2915	8.320	PROJ CONF VARIABLE CREDITS 1-10	10		TBA				CC 202		DALLMANN,C	
	2920	8.325	M+P TOOLS EQUIP	02	M W	1.00		1		CC 202E		DALLMANN,C	
	2925	8.328	M+P SOUPS SAUCES	02	T-H	1.00		1		CC 202E		DALLMANN,C	
AUTO BODY REPAIR Special Admission Procedure													
	2930	3.511	AUTO BODY RPR I	12	MTWH	8.00		5		IA 124		THORNTON,L	OPT
	2935	3.512	AUTO BODY RPR II	12	MTWH	8.00		5		IA 124		THORNTON,L	OPT
	2940	3.513	AUTO BODY RPR III	12	MTWH	8.00		5		IA 124		THORNTON,L	OPT
	2945	3.514	AUTO BODY RPR IV	12	MTWH	8.00		5		IA 124		THORNTON,L	OPT
	2950	3.515	AUTO BODY RPR V	12	MTWH	8.00		5		IA 124		THORNTON,L	OPT
	2955	3.516	AUTO BODY RPR VI	12	MTWH	8.00		5		IA 124		THORNTON,L	OPT
	2960	3.511	AUTO BODY RPR I	12	MTWH	12.00		5		IA 124		HYSMITH,E	OPT
	2965	3.512	AUTO BODY RPR II	12	MTWH	12.00		5		IA 124		HYSMITH,E	OPT
	2970	3.513	AUTO BODY RPR III	12	MTWH	12.00		5		IA 124		HYSMITH,E	OPT
	2975	3.514	AUTO BODY RPR IV	12	MTWH	12.00		5		IA 124		HYSMITH,E	OPT
	2980	3.515	AUTO BODY RPR V	12	MTWH	12.00		5		IA 124		HYSMITH,E	OPT
	2985	3.516	AUTO BODY RPR VI	12	MTWH	12.00		5		IA 124		HYSMITH,E	OPT
AUTOMOTIVE TECHNOLOGY Special Admission Procedure													
	2990	3.295	AUTO MECHANICS I	12	MTWHF	8.00		4		IA 117		CARTER,D	
	2995	3.298	AUTO MECHANICS IV	12	MTWHF	1.00		4		IA 117		POND,K	
Continuing Students must have instructor approval and will be assigned to either Auto Mechanics I or IV.													
MACHINE TOOL TECHNOLOGY Special Admission Procedure for Curriculum Classes													
CURRICULUM CLASSES													
	3000	3.403	MACHINE TOOL I	10	MTWH	8.00		5		IB 101		GRIFFITHS,J	
	3005	3.404	MACHINE TOOL II	10	MTWH	8.00		5		IB 101		GRIFFITHS,J	
	3010	3.405	MACHINE TOOL III	10	MTWH	8.00		5		IB 101		GRIFFITHS,J	
	3015	3.406	MACHINE TOOL IV	10	MTWH	8.00		5		IB 101		GRIFFITHS,J	
	3020	3.407	MACHINE TOOL V	10	MTWH	8.00		5		IB 101		GRIFFITHS,J	
	3025	3.408	MACHINE TOOL VI	10	MTWH	8.00		5		IB 101		GRIFFITHS,J	

P	TLN	COURSE NUMBER	COURSE TITLE	CR	START TIME			RM LOC	RM	INSTRUCTOR	P/NP
					MTWHF	TIME	N DUR				
	3030	3.403	MACHINE TOOL I	10	MTWH	12.00	5	IB 101		BURKE,M	
	3035	3.404	MACHINE TOOL II	10	MTWH	12.00	5	IB 101		BURKE,M	
	3040	3.405	MACHINE TOOL III	10	MTWH	12.00	5	IB 101		BURKE,M	
	3045	3.406	MACHINE TOOL IV	10	MTWH	12.00	5	IB 101		BURKE,M	
	3050	3.407	MACHINE TOOL V	10	MTWH	12.00	5	IB 101		BURKE,M	
	3055	3.408	MACHINE TOOL VI	10	MTWH	12.00	5	IB 101		BURKE,M	
NON-CURRICULUM CLASSES											
	3060	3.380	MACHINE TOOL I	02	M	6.30	N 3	IB 101		LINVILLE,L	
	3065	3.381	MACHINE TOOL II	02	M	6.30	N 3	IB 101		LINVILLE,L	
	3070	3.382	MACHINE TOOL III	02	M	6.30	N 3	IB 101		LINVILLE,L	
	3075	3.383	MACHINE TOOL IV	02	M	6.30	N 3	IB 101		LINVILLE,L	
	3080	3.384	MACHINE TOOL V	02	M	6.30	N 3	IB 101		LINVILLE,L	
	3085	3.385	MACHINE TOOL VI	02	M	6.30	N 3	IB 101		LINVILLE,L	
	3090	3.380	MACHINE TOOL I	02	W	6.30	N 3	IB 101		LINVILLE,L	
	3095	3.381	MACHINE TOOL II	02	W	6.30	N 3	IB 101		LINVILLE,L	
	3100	3.382	MACHINE TOOL III	02	W	6.30	N 3	IB 101		LINVILLE,L	
	3105	3.383	MACHINE TOOL IV	02	W	6.30	N 3	IB 101		LINVILLE,L	
	3110	3.384	MACHINE TOOL V	02	W	6.30	N 3	IB 101		LINVILLE,L	
	3115	3.385	MACHINE TOOL VI	02	W	6.30	N 3	IB 101		LINVILLE,L	
	3120	4.130	MACHINE PROCESSES	02	F	10.00	3	IB 101		BURKE,M	
	3125	4.130	MACHINE PROCESSES	02	F	12.00	3	IB 101		GRIFFITHS,J	
METALLURGICAL TECHNOLOGY											
	3130	4.161	MTLS TESTING	02	H	4.30	4	IA 101		LOVE,C	
	3135	6.293	INTRO/METLRGY	06	T-H	1.30	3	ST 109		LOVE,C	
	3140	6.293	INTRO/METLRGY	06	M W	7.00	N 3	ST 217B		WEBSTER,T	
	3145	6.281	NONDESTRUCT TEST	02	M W	4.30	2.5	IA 101		LOVE,C	
	3150	6.298	METALLOGRAPHY	02	T	4.30	4	ST 215		LOVE,C	
SMALL ENGINE/RECREATIONAL VEHICLE REPAIR											
Special Admission Procedure											
	3155	3.560	SMALL ENGINES I	10	MTWH	12.00	5	IB 110		HANSEN,L	
	3160	3.561	SMALL ENGINES II	10	MTWH	12.00	5	IB 110		HANSEN,L	
	3165	3.562	SMALL ENGINES III	10	MTWH	12.00	5	IB 110		HANSEN,L	
	3170	3.563	SMALL ENGINES IV	10	MTWH	12.00	5	IB 110		HANSEN,L	
	3175	3.570	REC VEHICLE I	10	MTWH	12.00	5	IB 110		HANSEN,L	
	3180	3.571	REC VEHICLE II	10	MTWH	12.00	5	IB 110		HANSEN,L	
WELDING											
Special Admission Procedure for Curriculum Classes											
CURRICULUM CLASSES											
	3185	4.151	WELDING I (AUTO)	03	F	8.00	5	IA 105		STAFF	
	3190	4.151	WELDING AUTO-BODY	03	F	12.00	5	IA 105		STAFF	
	3195	4.151	WELDING I (METAL)	03	F	12.00	5	IA 105		STAFF	
	3200	4.240	BASIC ARC WELD LAB	06	MTWH	9.00	3	IA 105		ALVIN,J	
					F	1.00	2	IA 105		ALVIN,J	
	3205	4.240	BASIC ARC WELD LAB	06	MTWH	12.00	3	IA 105		STEWART,E	
					F	1.00	2	IA 105		ALVIN,J	
	3210	4.255	FAB. + RPR. PRAC	06	T-H	9.00	7	IA 105		STAFF	

P	TLN	COURSE NUMBER	COURSE TITLE	START			RM LOC	RM	INSTRUCTOR	P/NP	
				CR	MTWHF	TIME					N
	3215	4.242	BASIC OXY WELD	04	MTWH	1.00	2	IA 105	ALVIN,J		
	3220	4.242	BASIC OXY WELD	04	MTWH	9.00	2	IA 105	STEWART,E		
NON-CURRICULUM CLASSES											
P	3225	9.148	PREP/CERT WELD MANUAL ARC-PIPE	04	T-H	6.00	N 4	IA 105	STEWART,D		
P	3230	9.148	PREP/CERT WELD SEMI AUTO WIRE-PIPE	04	T-H	6.00	N 4	IA 105	STEWART,D		
	3235	9.151	BEG WELDING	02	M	6.00	N 4	IA 105	WIROWEK,R		
	3240	9.151	BEG WELDING	02	SAT	8.00	4	IA 105	WIROWEK,R		
	6155	9.151	WELDING, BEG SEE COMMUNITY EDUCATION LISTING FOR THIS TLN								
	6275	9.151	WELDING I								
	6280	9.151	WELDING I SEE BENTON CENTER LISTING FOR THESE TLN'S								
	6330	9.151	WELDING SEE SANTIAM CENTER LISTING FOR THIS TLN								
	6380	9.151	WELDING I SEE EAST LINN CENTER LISTING FOR THIS TLN								
P	3245	9.152	ADV WELDING	02	F	6.00	N 4	IA 105	RADKE,E		
P	3250	9.152	ADV WELDING	02	W	6.00	N 4	IA 105	ALVIN,J		
P	6385	9.152	WELDING II SEE EAST LINN CENTER LISTING FOR THIS TLN								
CONSTRUCTION TECHNOLOGY/CARPENTRY Special Admission Procedure											
	3255	3.200	WOOD TECHNOLOGY	10	MTWHF	12.30	4	1B 120	DAY,H		

## HUMANITIES and SOCIAL SERVICES DIVISION

ART											
	3260	AR101	WEAVING I Required \$5.00 Charge for Take-Home Materials	03	M W F	10.00	2	H 121	NELSON,S	OPT	
P	3265	AR102	WEAVING II Required \$5.00 Charge for Take-Home Materials	03	M W F	10.00	2	H 121	NELSON,S	OPT	
	3270	AR195	BASIC DESIGN	03	M W F	10.00	2	H 120	BRICK,J	OPT	
	3275	AR195	BASIC DESIGN	03	T-H	9.30	3	H 121	NELSON,S	OPT	
	6285	AR195	BASIC DESIGN SEE SANTIAM CENTER LISTING FOR THIS TLN								
	3280	AR201	SURVEY OF VIS ART	03	W	7.00	N 3	H 209	TOBEY,G	OPT	
	3285	AR204	INTRO TO ART HIST	03	M W	2.00	1.5	H 209	BRICK,J	OPT	
	3290	AR235	JEWELRY + METAL I Required \$5.00 Charge for Take-Home Materials	03	M W	1.00	3	H 118	TOBEY,G	OPT	
P	3295	AR236	JEWELRY + MTL II Required \$5.00 Charge for Take-Home Materials	03	M W	1.00	3	H 118	TOBEY,G	OPT	

P	TLN	COURSE NUMBER	COURSE TITLE	START			RM LOC	RM	INSTRUCTOR	P/NP
				CR	MTWHF	TIME				
	3300	AR255	CERAMICS I Required \$3.00 Charge for Take-Home Materials	03	M W	9.00	3	H 116	TOBEY,G	OPT
P	3305	AR256	CERAMICS II Required \$3.00 Charge for Take-Home Materials	03	M W	9.00	3	H 116	TOBEY,G	OPT
	3310	AR255	CERAMICS I Required \$3.00 Charge for Take-Home Materials	03	T-H	9.30	3	H 116	TOBEY,G	OPT
P	3315	AR256	CERAMICS II Required \$3.00 Charge for Take-Home Materials	03	T-H	9.30	3	H 116	TOBEY,G	OPT
	3320	AR293	ELEM SCULP	03	T-H	1.00	3	H 118	TOBEY,G	OPT
	3325	AR292	WATER COLOR PAINT	03	T-H	1.00	3	H 120	BRICK,J	OPT
	3330	AR290	PAINTING I	03	T-H	9.30	3	H 120	BRICK,J	OPT
P	3335	AR296	PAINTING II	03	T-H	9.30	3	H 120	BRICK,J	OPT
	3340	AR291	FUND DRAWING	03	M W F	8.00	2	H 116	NELSON,S	OPT
	3345	AR291	FUND DRAWING	03	M W F	1.00	2	H 120	NELSON,S	OPT

CRIMINAL JUSTICE ADMINISTRATION

	3350	CJ111	INTRO TO CRIM JUS	03	M W F	10.00	1	H 209	HANKEY,R	
	3355	CJ111	INTRO TO CRIM JUS	03	M W F	1.00	1	H 209	HANKEY,R	
	3360	CJ111	INTRO TO CRIM JUS	03	W	7.00	N 3	H 211	HANKEY,R	
P	3365	CJ213	LEGAL ASPECTS-EVD	03	M W F	9.00	1	H 209	HANKEY,R	
P	3370	CJ219	COMMUNITY RLNS	03	M	7.00	N 3	H 209	DIEU,F	
P	3375	5.230	FUND CRIME/DEL	03	M W F	11.00	1	H 209	HANKEY,R	
	3380	5.231	CIVIL PROCEDURES	03	T	7.00	N 3	H 211	HOUCHIN,L	
P	3385	5.220	CONCEPTS ENF SVC	03	H	7.00	N 3	H 209	STAFF	

DRAMA - SPEECH

	3390	SP111	BEG ORAL COMM	03	M W F	9.00	1	F 202	AYERS,M	
	3395	SP111	BEG ORAL COMM	03	M W F	11.00	1	F 202	ROSSBERG,S	
	3400	SP111	BEG ORAL COMM	03	T-H	9.30	1.5	F 202	AYERS,M	
	3405	SP111	BEG ORAL COMM	03	T-H	1.00	1.5	F 202	AYERS,M	
	3410	SP111	BEG ORAL COMM	03	M	7.00	N 3	F 202	AYERS,M	
P	3415	SP112	INTER ORAL COMM	03	M W F	11.00	1	F 204	AYERS,M	
	3420	SP229	INTERP READING	03	M W F	1.00	1	F 104	AYERS,M	
	3425	TH202	INTRO TO THEATRE	03	M W F	1.00	1	H 211	ROSSBERG,S	
	3430	TH248	BEG ACTING	03	M W F	10.00	1	F 104	ROSSBERG,S	OPT
	3435	TH249	STAGE CRAFT	03	T-H	9.30	1.5	F 104	VOGLER,S	
P	3440	TH250	THEATRE WORKSHOP VARIABLE CREDIT 1-3	03		TBA		F 104	ROSSBERG,S	OPT

ENGLISH - JOURNALISM - FOREIGN LANGUAGE

	3445	EN101	SURVEY ENG LIT	03	M W F	11.00	1	H 220	BERVIN,A	
	3450	EN104	INTRO TO LIT	03	M W F	8.00	1	H 209	WILLIAMS,BJ	
	3455	EN104	INTRO TO LIT	03	T-H	8.00	1.5	H 211	MINNICK,D	
	3460	EN104	INTRO TO LIT	03	M W F	1.00	1	LRC 207	CALL,S	
	3465	EN104	INTRO TO LIT	03	T	7.00	N 3	H 209	CHENEY,K	
	6265	EN104	INTRO TO LIT SEE BENTON CENTER LISTING FOR THIS TLN							
	6315	EN104	INT TO LIT SEE SANTIAM CENTER LISTING FOR THIS TLN							

P	TLN	COURSE NUMBER	COURSE TITLE	START			RM LCL	RM	INSTRUCTOR	P/NP
				CR	MTWHF	TIME				
	6370	EN104	INTRO TO LIT SEE EAST LINN CENTER LISTING FOR THIS TLN							
	3470	EN105	INTRO TO LIT	03	M W F	10.00	1	LRL 117	CHASE,T	
	3475	EN199	LIT OF SCI FCTN	03	M W F	9.00	1	H 220	BERVIN,A	
	3480	EN201	SHAKESPEAR	03	M W F	10.00	1	LRL 207	MINNICK,D	
	3485	EN253	SURVEY AMER LIT	03	M W F	9.00	1	B 107	CHASE,T	
	3490	WR121	ENG COMP	03	M W F	2.00	1	U 202	SWEET,W	
	3495	WR121	ENG COMP	03	M W F	9.00	1	U 202	SWEET,W	
	3500	WR121	ENG COMP	03	M W F	10.00	1	F 204	WILLIAMS,BJ	
	3505	WR121	ENG COMP	03	M W F	10.00	1	H 220	BERVIN,A	
	3510	WR121	ENG COMP	03	M W F	11.00	1	B 101	WILLIAMS,BJ	
	3515	WR121	ENG COMP	03	M W F	1.00	1	H 220	WILLIAMS,BJ	
	3520	WR121	ENG COMP	03	T-H	8.00	1.5	H 220	BERVIN,A	
	3525	WR121	ENG COMP	03	T-H	1.00	1.5	U 202	SWEET,W	
	3530	WR121	ENG COMP	03	T-H	2.30	1.5	U 202	SWEET,W	
	3535	WR121	ENG COMP	03	W	7.00	N 3	F 202	BERVIN,A	
	6270	WR121	ENG COMP SEE BENTON CENTER LISTING FOR THIS TLN							
	6310	WR121	ENG COMP SEE SANTIAM CENTER LISTING FOR THIS TLN							
	6365	WR121	ENG COMP							
	6395	WR121	ENG COMP SEE EAST LINN CENTER LISTING FOR THESE TLN'S							
	3540	WR122	ENG COMP	03	M W F	9.00	1	LRL 117	CALL,S	
	3545	WR122	ENG COMP	03	M W F	2.00	1	LRL 211	CALL,S	
	3550	WR199	JOURNAL WRITING	03	H	7.00	N 3	H 211	WILLIAMS,BJ	OPT
	3555	WR241	INTRO TO CR WRIT	03	M W F	1.00	1	U 202	SWEET,W	OPT
	3560	WR243	INTRO TO CR WRIT	03	M W F	1.00	1	U 202	SWEET,W	OPT
	3565	WR241	INTRO TO CR WRIT	03	H	7.00	N 3	U 202	SWEET,W	OPT
P	3570	WR243	INTRO TO CR WRIT	03	H	7.00	N 3	U 202	SWEET,W	OPT
	6360	WR242	INTRO IMAG WRT SEE EAST LINN CENTER LISTING FOR THIS TLN							
	3575	1.101	COM SK I	03	M W F	8.00	1	LRL 209	SPIKER,J	
	3580	1.101	COM SK I	03	M W F	9.00	1	LRL 209	SPIKER,J	
	3585	1.101	COM SK I	03	M W F	10.00	1	LRL 209	CALL,S	
	3590	1.101	COM SK I	03	M W F	11.00	1	LRL 209	MINNICK,D	
	3595	1.101	COM SK I	03	M W F	1.00	1	LRL 209	MINNICK,D	
	3600	1.101	COM SK I	03	M W F	2.00	1	LRL 209	MINNICK,D	
	3605	1.101	COM SK I	03	M W F	2.00	1	LRL 207	CHASE,T	
	3610	1.101	COM SK I	03	T-H	8.00	1.5	LRL 209	CHASE,T	
	3615	1.101	COM SK I	03	T-H	1.00	1.5	LRL 209	CHASE,T	
	3620	1.101	COM SK I	03	T	7.00	N 3	LRL 117	CALL,S	
	3625	1.102	COM SK II	03	T-H	8.00	1.5	LRL 211	VINCENT,R	
	3630	1.102	COM SK II	03	T-H	9.30	1.5	LRL 211	VINCENT,R	
	3635	1.112	TECH RPT WR	03	M W F	9.00	1	F 204	CANNON,S	
	3640	JN215	JOURNALISM LAB	01		TRA	3		SPIKER,J	
	3645	JN216	REPORTING I	03	M W F	11.00	1	CL 210	SPIKER,J	
	3650	RL 60	FIRST YR SPANISH	04	T-H	1.00	2	LRL 117	MALTYB,S	

P	TLN	COURSE		CR	MTWHF	START		N	DUR	RM		INSTRUCTOR	P/NP
		NUMBER	COURSE TITLE			TIME				LOC	RM		
GRAPHIC COMMUNICATIONS													
	3655	3.150	INTRO GRAPHIC COM	03	M W F	1.00		1		H 121		WRIGHT,D	
	3660	3.151	PUBLICATION DSGN	03	M W F	2.00		1		F 109		SPIKER,J	
	3665	3.162	INTRO TO PHOTO	03	M W F	1.00		2		F 107		WALDRON,D	
			Required \$5.00 Charge for Take-Home Materials										
	3670	3.164	BSC GR ARTS PHOTO	03	T-H	1.00		3		F 107		WALDRON,D	
	3675	3.166	GRAPHIC PROD I	03	T-H	8.00		3		F 109		WRIGHT,D	
P	3680	3.167	GRAPHIC PROD II	04	T-H	12.00		3		F 109		WRIGHT,D	
			Required \$5.00 Charge for Take-Home Materials										
P	3685	3.172	COMM ILLUS I	03	M W F	8.00		2		F 109		WRIGHT,D	
	3690	3.180	PUBLICATIONS LAB	02		TBA						SPIKER,J	
P	3695	3.181	PRODUCTION LAB	02		TBA						WRIGHT,D	
P	6340	9.611	PRINT METHOD II	SEE SANTIAM CENTER LISTING FOR THIS TLN									
HUMAN SERVICES													
	3700	7.135	AGES/STAGES INTRO	02	T-H	1.00		1		F 204		SCHREIBER,J	
	3705	7.140	TECH OBS BEHAVIOR	01		F 10.00		1		IA 210		SCHREIBER,J	
	3710	7.142	AGES/STGS ERLY-AD	03	M W F	1.00		1		B 104		SCHREIBER,J	
	3715	7.150	CHILD CARE PRAC I LAB	03	M W	2.00		1		IA 224		SCHREIBER,J	
						TBA							
	3720	7.153	BEHVRL OBJECTIVES	02	T-H	2.00		1		H 209		SCHREIBER,J	
P	3725	7.180	SUPVSD PLACEMENT LAB	04	T-H	8.00		1		IA 224		SCHREIBER,J	
						TBA							
MUSIC													
	3730	MU 50	BASIC PIANO	02	M W	11.00		1		H 210		RUPPERT,G	OPT
	3735	MU 51	BASIC VOICE	02	T-H	1.00		1		H 213		WEST,D	OPT
	3740	MU111	MUSIC THEORY I	04	MTWHF	10.00		1		H 213		RUPPERT,G	OPT
	3745	MU180	CLASS LSNS GUITAR	01	T-H	11.00		1		H 213		WEST,D	PNP
	3750	MU190	PERFORMANCE STDS \$37.50 TUTORIAL FEE	01		TBA						STAFF	
	3755	M195C	CONCERT BAND	01	T-H	1.00		1		H 213		RUPPERT,G	OPT
P	3760	M295C	CONCERT BAND	01	T-H	1.00		1		H 213		RUPPERT,G	OPT
	3765	M195S	STAGE BAND	02	M W F	1.00		1		H 213		RUPPERT,G	OPT
P	3770	M295S	STAGE BAND	02	M W F	1.00		1		H 213		RUPPERT,G	OPT
	3775	M197C	CONCERT CHOIR	01	M W	3.00		1		H 213		WEST,D	OPT
P	3780	M297C	CONCERT CHOIR	01	M W	3.00		1		H 213		WEST,D	OPT
	3785	M197S	SWING CHOIR	02	H	3.00		1		H 213		WEST,D	OPT
					T	7.00	N	2		H 213		WEST,D	
INSTRUCTOR PERMISSION REQUIRED													
P	3790	M297S	SWING CHOIR	02	H	3.00		1		H 213		WEST,D	OPT
					T	7.00	N	2		H 213		WEST,D	
INSTRUCTOR PERMISSION REQUIRED													
	3795	MU201	INTRO MUSIC LIT	03	M W F	11.00		1		H 213		WEST,D	OPT
P	3800	MU211	MUSIC THEORY II	03	T-H	11.00		1.5		H 210		RUPPERT,G	OPT
P	3805	MU214	KEYBOARD HARMONY	01	T-H	12.00		1		H 213		RUPPERT,G	OPT

P	TLN	COURSE NUMBER	COURSE TITLE	CR	MTWTF	START		N	DUR	RM LOC	RM	INSTRUCTOR	P/NP
						TIME							
P	3810	MU290	PERFMNC STUDIES \$37.50 TUTORIAL FEE	01		TBA						STAFF	
	3815	MU101	BASIC MUSICIANSHP	03	T-H	9.30		1.5		H 210		WEST,D	OPT
PHILOSOPHY & RELIGION													
	3820	PH201	PROBLEMS OF PHIL	03	T-H	8.00		1.5		B 107		CRAWFORD,E	
	3825	PH204	PHIL OF RELIGION	03	M	7.00	N	3		H 211		CRAWFORD,E	
	3830	RF201	RELIGIONS OF WRLD	03	T	9.30		3		H 211		EICHELBERGER	
SOCIAL SCIENCE													
ANTHROPOLOGY													
	3835	AN207	CULTURAL ANTROPLG	03	M	7.00	N	3		B 104		TAYLOR,A	
	<u>6260</u>	AN101	GEN ANTHROPOLOGY SEE BENTON CENTER LISTING FOR THIS TLN										
ECONOMICS													
	3840	EC201	PRIN OF ECONOMICS	03	M W F	9.00		1		F 115		CONNERS,G	
	3845	EC201	PRIN OF ECONOMICS	03	H	7.00	N	3		F 115		CONNERS,G	
EDUCATION													
	3850	ED210	ED PRACTICUM	06		TBA						ADAMS,O	PNP
FAMILY LIVING													
	3855	FL222	MARRIAGE PREPRTN	03	M W F	1.00		1		U 205A		WILLIAMS,L	OPT
GEOGRAPHY													
	3860	GE105	INTRO TO GEOG	03	M W F	8.00		1		U 205A		HENDERLY,H	
	3865	GE105	INTRO TO GEOG	03	H	7.00	N	3		U 205A		HENDERLY,H	
	<u>6240</u>	GE105	INTRO GEOGRAPHY SEE BENTON CENTER LISTING FOR THIS TLN										
HISTORY													
	3870	HS101	WEST CIV	03	M W F	9.00		1		B 101		DURHAM,R	
	3875	HS101	WEST CIV	03	M W F	2.00		1		U 207A		DURHAM,R	
	3880	HS101	WEST CIV	03	T-H	9.30		1.5		H 209		DURHAM,R	
	<u>6255</u>	HS101	WESTERN CIV SEE BENTON CENTER LISTING FOR THIS TLN										
	3885	HS199	TOWARDS YR 2000	03	M W F	12.00		1		U 216		CLARK,D	OPT
	3890	HS201	US HIST	03	M W F	8.00		1		B 101		DURHAM,R	
	3895	HS201	US HIST	03	M W F	1.00		1		U 207A		DURHAM,R	
	3900	HS201	US HIST	03	T-H	11.00		1.5		H 209		DURHAM,R	
POLITICAL SCIENCE													
	3905	PS201	AM GOV	03	M W F	10.00		1		U 216		CLARK,D	
	3910	PS201	AM GOV	03	M W F	1.00		1		U 216		CLARK,D	

P	COURSE		CR	MTWHF	START		RM	RM	INSTRUCTOR	P/NP
	TLN	NUMBER			COURSE TITLE	TIME				
	3915	PS205		M W F	9.00	1				
	3920	1.124		T-H	9.30	1.5	0	216	CLARK,D	
							0	216	CLARK,D	
	3925	PY201		M W F	9.00	1		H 211	MONTGOMERY,M	
	3930	PY201		M W F	1.00	1		IA 224	MONTGOMERY,M	
	3935	PY201		T-H	1.00	1.5		H 211	MONTGOMERY,M	
	3940	PY201		W	7.00	N 3		IA 210	MONTGOMERY,M	
	<b>6250</b>	PY201								
		SEE BENTON CENTER LISTING FOR THIS TLN								
	<b>6325</b>	PY201								
		SEE SANTIAM CENTER LISTING FOR THIS TLN								
P	3945	PY202		M W F	11.00	1		H 211	MONTGOMERY,M	
	3950	PY231		T-H	1.00	1.5		IA 224	ACKERMAN,M	OPT
	3955	PY231		T	7.00	N 3		IA 212	SNYDER,A	OPT
	3960	1.606		M W F	8.00	1		IA 212	ANDREASEN,G	OPT
	3965	1.606		M W F	11.00	1		IA 210	ANDREASEN,G	OPT
	3970	1.606		M W F	1.00	1		B 107	ANDREASEN,G	OPT
		SOCIOLOGY								
	3975	S0204		M W F	8.00	1		F 115	LIEBERMAN,M	
	3980	S0204		M W F	10.00	1		F 115	LIEBERMAN,M	
	3985	S0204		T-H	9.30	1.5		F 113	LIEBERMAN,M	
	3990	S0204		T	7.00	N 3		F 202	LIEBERMAN,M	
	<b>6245</b>	S0204								
		SEE BENTON CENTER LISTING FOR THIS TLN								
	<b>6405</b>	S0204								
		SEE EAST LINN CENTER LISTING FOR THIS TLN								
	3995	S0206		M W F	1.00	1		IA 212	LIEBERMAN,M	
	4000	S0199		M W F	9.00	1		IA 212	ANDREASEN,G	OPT
		FOR WOMEN AND MEN								
	4005	S0199		H	7.00	N 3		IA 212	ANDREASEN,G	OPT
		FOR WOMEN AND MEN								

## SCIENCE-TECHNOLOGY DIVISION

### AGRICULTURE TECHNOLOGY

#### PLANT SCIENCE

	4010	8.100		M	12.00	1		ST 211	JOHNSON/MOOS	OPT
	4015	8.125		M W	9.00	1		ST 211	JOHNSON,H	
				F	9.00	2		ST 211	JOHNSON,H	
	4020	8.137		M W	2.00	1		ST 211	JOHNSON,H	
				W	3.00	2		ST 211	JOHNSON,H	



P	TLN	COURSE NUMBER	COURSE TITLE	START			RM		INSTRUCTOR	P/NP
				CR	MTWHF	TIME	N	DUR		
	4025	8.138	IRRIG/DRAINAGE LAB	03	M F W	11.00 11.00	1 2	ST 211 ST 211	JOHNSON,H JOHNSON,H	
	4030	8.140	LANDSCAPE MAINT LAB	03	T-H T	1.00 2.00	1 2	ST 211 ST 211	JOHNSON,H JOHNSON,H	
	4035	8.165	PLANT SCIENCE LAB	04	MTW H	10.00 9.00	1 2	ST 211 ST 211	JOHNSON,H JOHNSON,H	
P	4040	8.220	LEADERSHIP-AG	01		TBA			JOHNSON/MOOS	
P	4045	1.200	SFE-AG 1-12 CREDITS	12		TBA			MOOS,B	
	6150	9.813	AG CHEM STARTS 11/6/75 CONTINUES WINTER TERM	03	H	7.00	N 3	CLHS 801	JOHNSON,H	OPT
			ANIMAL SCIENCE							
	4050	8.160	INT/AN SCIENCE LAB	04	MTW H	10.00 9.00	1 2	ST 208 ST 208	MOOS,B MOOS,B	
	4055	9.817	INT/AN SCIENCE LAB	04	MTW H	10.00 9.00	1 2	ST 208 ST 208	MOOS,B MOOS,B	
	4060	8.158	ART INSEMINATION	03	W	2.00	3	ST 208	MOOS,B	
	4065	9.822	ART INSEMINATION	03	W	2.00	3	ST 208	MOOS,B	
	4070	8.153	LVSTK PROD I-BEEF	04	T-H H	1.00 3.00	2 1	ST 217B ST 217B	MOOS,B MOOS,B	
	6345	9.817	LVSTK CARE/MNGT SEE EAST LINN CENTER LISTING FOR THIS TLN							
	4075	8.151	HRSMNSHP/HRS HSBM	03	W SAT	7.00 9.00	N 2 3	ST 211 ST 211	MOELLER,A MOELLER,A	
	6005	9.818	HRSMNSHP/HRS HSBM SEE COMMUNITY EDUCATION LISTING FOR THIS TLN							
			FARM MANAGEMENT							
	4080	9.835	FRM MGT-REC ANL I FIRST CLASS MEETING	02		TBA 10/14/75			CUSHMAN,J	
	4085	9.836	FRM MGT-RC ANL II FIRST CLASS MEETING	02		TBA 10/7/75			CUSHMAN,J	
			BIOLOGICAL SCIENCES							
	4090	BI101	BIOLOGY	04	M W F	9.00	1	F 104	ROSS,R	
	4091	BI101	LAB 1		T	9.00	2	ST 204	ROSS,R	
	4092	BI101	LAB 2		T	11.00	2	ST 204	ROSS,R	
	4093	BI101	LAB 3		T	2.00	2	ST 204	ROSS,R	
	4095	BI101	GEN BIO-GENETICS	04	M W F	1.00	2	ST 204	ROSS,R	
	4100	BI101	GEN BIO-MICROBIO	04	W F	12.00	3	ST 202	STAFF	
	4105	BI103	GEN BIO-AQUATIC LAB	04	W SAT	2.00 9.00	2 3	IA 212 IA 212	WOOLEY,J WOOLEY,J	
	4110	BI101	GEN BIOLOGY SCIENCE ETHICS + PROGRESS	04	M W F	11.00	2	ST 204	MULLIKIN,C	
	4115	BI101	GEN BIOLOGY	04	M W	7.00	N 3	ST 204	HEATON,L	

P	TLN	COURSE NUMBER	COURSE TITLE	START			RM LOC	RM	INSTRUCTOR	P/NP
				CR	MTWHF	TIME				
	4120	B0201	GEN BOTANY	04	T-H	1.00	3	ST 202	CHAMBERS,H	
	<u>6320</u>	B0201	GEN BOTANY SEE SANTIAM CENTER LISTING FOR THIS TLN							
	4125	4.211	NUTRITION I	03	T-H	1.30	1.5	U 205A	BURSON,J	
	4130	BI221	HUMAN BIOLOGY	04	M W F	1.00	1	ST 119	BAKER,J	
	4131		LAB 1		M W	10.00	2	ST 202	BAKER,J	
	4132		LAB 2 PREFERENCE FOR NURSING PROGRAM IN LAB 2		M W	2.00	2	ST 202	BAKER,J	
	4135	8.300	FOOD MICRO I	03	M W	3.00	2	ST 204	STAFF	
	4140	GS199	SPECIAL TOPIC VARIABLE CREDITS 1-4	04		TBA			ROSS,R	
	4145	4.221	INT BASIC SCI DNT	03	T-H	1.00	2	ST 208	BAKER,J	
	4150	Z 201	GEN ZOOLOGY	03	T-H	8.00	3	ST 202	BAKER,J	
ENGINEERING TECHNOLOGY										
CIVIL/MECHANICAL TECHNOLOGY										
P	4155	4.119	MACHINE DRAFTING	04	T-H	9.00	3	ST 219	STAFF	
					F	10.00	2	ST 219	STAFF	
P	4160	4.126	MECH DES PRIN	03	M W F	1.00	1	ST 219	STAFF	
P	4165	4.113	SURVEYING	02	M W	10.00	2	ST 219	STAFF	
DRAFTING TECHNOLOGY										
SPECIAL ADMISSION PROCEDURE										
	4170	4.100	BLUPRNT RD (AUTO)	02	M W	3.00	2	IA 224	MILLER,D	
	4175	4.100	BLUPRNT RD-MACH	02	T-H	9.00	2	IA 224	REYNOLDS,J	
	4180	4.101	BLUPRNT RD (WELD)	02	T-H	3.00	2	IA 224	REYNOLDS,J	
	4185	3.429	BLUPRNT-CONST TRD	02	M W	10.00	2	IA 224	REYNOLDS,J	
	4190	4.124	TECH DRAW I-WELD	02	M W	8.00	2	SI 219	STAFF	
	4195	4.109	TECH SKETCHING-A	01	M W	1.00	1	ST 213	REYNOLDS,J	
	4200	4.109	TECH SKETCHING-B	01	T-H	1.00	1	ST 213	REYNOLDS,J	
	4205	4.110	DRAFTING LAB-A	03	M W	9.00	3	ST 213	MILLER,D	
	4210	4.110	DRAFTING LAB-B	03	T-H	9.00	3	ST 213	MILLER,D	
P	4215	4.114	ARCH DRAFTING	03	T-H	1.00	3.5	ST 219	MILLER,D	
	4220	4.102	DRAFT PRACTICES	03	M W F	2.00	1	F 115	REYNOLDS,J	
	<u>6070</u>	4.100	BLUPRNT READNG	02	T-H	7.00	N 2	ST 102	STAFF	
	<u>6335</u>	4.100	BLU-PRNT READING SEE SANTIAM CENTER LISTING FOR THIS TLN							
	<u>6390</u>	4.100	BLUEPRINT RDG SEE EAST LINN CENTER LISTING FOR THIS TLN							
ELECTRICITY/ELECTRONICS TECHNOLOGY										
SPECIAL ADMISSION PROCEDURE										
	4225	6.320	ELECT-ELECTRNCS I	06	MTWH	12.00	2	IA 237	HANSEN,K	
P	4230	6.321	ELECT-ELECTRNC II	06	MTWH	12.00	2	IA 237	HANSEN,K	
P	4235	6.323	ELECT-ELECTRN IV	10	MTWH	8.00	4	IA 237	HANSEN,K	
P	4240	6.322	ELECT-ELECTRN III	08	MTWH	8.00	3	IA 237	HANSEN,K	
	4245	6.330	GEN ELECTRICITY I	03	MTWH	11.00	1	IA 212	HANSEN,K	
	4250	6.316	INTRO TO E/E	01	T	2.00	1	IA 237	HANSEN,K	

P	TLN	COURSE		START			RM		INSTRUCTOR	P/NP
		NUMBER	COURSE TITLE	CR	MTWHF	TIME	N	DUR		
P	6100	6.320	ELECT/ELECTRON I	03	T	7.00	N	3	IA 237	HANSEN,K
P	6105	6.321	ELECT/ELECTRON II	03	T	7.00	N	3	IA 237	HANSEN,K
P	6110	6.322	ELEC/ELECTRON III	03	T	7.00	N	3	IA 237	HANSEN,K
P	6115	6.323	ELECT/ELECTRON IV	03	T	7.00	N	3	IA 237	HANSEN,K
P	6120	6.324	ELECT/ELECTRON V	03	T	7.00	N	3	IA 237	HANSEN,K
P	6125	6.325	ELECT/ELECTRON VI	03	T	7.00	N	3	IA 237	HANSEN,K
GENERAL ENGINEERING										
CLASSES TO BE ANNOUNCED BY SEPTEMBER 1										
ENVIRONMENTAL SCIENCE TECHNOLOGY										
REFRIGERATION, HEATING AND AIR CONDITIONING TECHNOLOGY										
SPECIAL ADMISSION PROCEDURE										
P	4255	3.530	REF/A-C/H FUND LAB	05	TWH M	1.00 12.00		1 2	IA 231 IA 231	VINCENT,M
P	4260	3.535	REF SYS I	06	T-H	2.00		3	IA 231	VINCENT,M
P	4265	3.537	REF SYS III LAB	04	M W T-H	9.00 9.00		1 2	IA 231 IA 231	VINCENT,M
P	4270	3.545	A-C SYS I LAB	04	T-H M W	11.00 10.00		1 2	IA 231 IA 231	VINCENT,M
P	4275	3.530	REF/A-C/H FUND	05	T-H	7.00	N	3	IA 231	MAGERS,H
P	4280	3.537	REF SYS III	04	T-H	7.00	N	3	IA 231	MAGERS,H
P	6065	3.530	REF/A-C FUND	05	M W	7.00	N	2.5	IA 231	STAFF
SCIENCE LABORATORY TECHNOLOGY										
CLASSES TO BE ANNOUNCED BY SEPTEMBER 1										
WATER/WASTEWATER TECHNOLOGY										
SPECIAL ADMISSION PROCEDURE										
	4285	6.101	INTRO/ENVIR TECH	03	T-H	11.00		1.5	IA 210	WOOLEY,J
	4290	6.114	SAN MICROBIOLOGY	04	M	9.00		2	IA 210	WOOLEY,J
	4291		LAB 1		W F	9.00		2	IA 235	
	4292		LAB 2		W F	11.00		2	IA 235	
	4295	6.151	WSTWTR TECH I	04	M W	1.00		3	IA 210	FELTON,J
P	4300	6.154	WSTWTR TECH IV	04	T-H	1.00		3	IA 210	FELTON,J
	4305	6.173	SAN CHEMISTRY I	04	T	1.00		1	IA 212	WOOLEY,J
	4306		LAB 1		T-H	3.00		2	IA 235	
	4307		LAB 2		T-H	9.00		2	IA 235	
	6080	6.158	SAN SEM (WATER)	02	W	7.00	N	2	IA 224	ARASMITH,E
	6085	6.158	SAN SEM-WSTWTR	02	H	7.00	N	2	IA 210	ARASMITH,E
FIRE SCIENCE										
	4310	4.205	BSC CHEM-FIRE SC	04	M W	7.00	N	2.5	ST 119	STAFF
	4315	5.260	HAZ MAT I	03	W	7.00	N	3	AFS	STAFF
	6090	9.310	FIRE FGHT SKL A	02		TBA				WRIGHT,G
	6095	9.311	FIRE FGHT SKLS B	02		TBA				WRIGHT,G

P	TLN	COURSE NUMBER	COURSE TITLE	START			RM LOC	RM	INSTRUCTOR	P/NP
				CR	MTWHF	TIME				
MATHEMATICS										
	4320	1.109	PRE BUSINESS MATH	03	MTW F	8.00	1	LRC 217	WRIGHT,E	PNP
	4325	1.109	PRE BUSINESS MATH	03	MTW F	11.00	1	LRC 211	WRIGHT,E	PNP
	4330	1.109	PRE BUSINESS MATH	03	MTWH	12.00	1	LRC 217	PERKINS,R	PNP
	4335	1.109	PRE BUSINESS MATH	03	T-H	7.00	N 2	LRC 217	SPLETSTOSER,	PNP
	4340	1.109	PRE BUSINESS MATH	03	MTWH	1.00	1	ST 130	RODECAP,S	PNP
	4345	1.110	ELEM OF ALGEBRA	04	M H	10.00	1	ST 119	PERKINS,R	OPT
	4346		LAB 1		T F	10.00	1	LRC 203	PERKINS,R	
	4347		LAB 2		T F	11.00	1	LRC 203	PERKINS,R	
			STUDENTS MUST REGISTER FOR LAB 1 OR 2							
	4350	1.110	ELEM OF ALGEBRA	04	M W	12.00	1	ST 119	REED,W	OPT
	4351		LAB 3		T F	1.00	1	LRC 203	REED,W	
	4352		LAB 4		T F	2.00	1	LRC 203	REED,W	
			STUDENTS MUST REGISTER FOR LAB 3 OR 4							
	4355	1.110	ELEM OF ALGEBRA	04	M W	7.00	N 2	ST 102	STAFF	OPT
	<u>6210</u>	1.110	ELEM OF ALGEBRA	SEE BENTON CENTER LISTING FOR THIS TLN						
P	4360	MT 95	INT ALGEBRA	04	T-H	7.00	N 2	ST 119	MICHAELS,J	
P	4365	MT 95	INT ALGEBRA	04	T F	2.00	1	O 216	MORGAN,M	
	4366		LAB 5		M W	1.00	1	LRC 203	MORGAN,M	
	4367		LAB 6		M W	2.00	1	LRC 203	MORGAN,M	
			STUDENTS MUST REGISTER FOR LAB 5 OR 6							
P	4370	MT 95	INT ALGEBRA	04	MTW F	11.00	1	LRC 207	MORGAN,M	
P	<u>6400</u>	MT 95	INTERMED ALGEBRA	SEE EAST LINN CENTER LISTING FOR THIS TLN						
P	4375	MT101	COLLEGE ALGEBRA	04	MTW F	10.00	1	ST 102	WRIGHT,E	
P	4380	MT101	COLLEGE ALGEBRA	04	MTW F	1.00	1	ST 102	WRIGHT,E	
P	4385	MT102	TRIGONOMETRY	04	MTW F	11.00	1	ST 130	REED,W	
P	<u>6215</u>	MT102	TRIGONOMETRY	SEE BENTON CENTER LISTING FOR THIS TLN						
P	4390	MT110	ANAL GEOM	04	MTW F	10.00	1	ST 130	STAFF	
P	4395	MT161	MTH NON-SCI MAJOR	04	MTW F	9.00	1	ST 102	MORGAN,M	
P	<u>6375</u>	MT161	MATH/NON-SCI MJRS	SEE EAST LINN CENTER LISTING FOR THIS TLN						
P	4400	MT162	MTH NON SCI MJR	04	MTW F	2.00	1	ST 130	STAFF	
P	4405	MT200	CALCULUS	04	MTW F	11.00	1	ST 102	RASMUSSEN,S	
P	4410	MT213	INTRO NUM COMP	04	T-H	1.00	1.5	B 107	MORAN,J	OPT
			LAB-FORTRAN			TBA	3			
P	4415	MT241	LINEAR ALGEBRA	04	MTW F	9.00	1	LRC 207	REED,W	
	4420	4.200	MATH I	04	MTW F	8.00	1	LRC 217	WRIGHT,E	PNP
	4425	4.200	MATH I	04	MTW F	11.00	1	LRC 211	WRIGHT,E	PNP
	4430	4.200	MATH I	04	MTWH	12.00	1	LRC 217	PERKINS,R	PNP
	4431	4.200	MATH I	04	MTWH	1.00	1	ST 130	RODECAP,S	PNP
	4435	4.200	MATH I	04	T-H	7.00	N 2	LRC 217	SPLETSTOSER,	PNP
P	4440	4.202	MATH II	04	MTWHF	8.00	1	ST 109	SWEARINGEN,D	
P	4445	4.202	MATH II	04	MTWHF	11.00	1	O 216	RODECAP,S	
P	4450	4.202	MATH II	04	T-H	7.00	N 2.5	ST 130	CHRISTIANSEN	
	<u>4455</u>	6.550	PRE-TECH MATH	04	MTW F	8.00	1	ST 102	STAFF	
	<u>6075</u>	6.550	PRE-TECH MATH	04	M W	7.00	N 2	LRC 217	BACKEUS,D	

COURSE		COURSE TITLE	START			RM	RM	INSTRUCTOR	P/NP	
P	TLN NUMBER		CR	MTWHF	TIME N DUR					LOC
P	4460	6.551	TECH MATH I	04	MTW F	8.00	1	ST 130	MORGAN,M	
P	4465	6.551	TECH MATH I	04	MTW F	1.00	1	LRC 211	STAFF	
P	4470	6.553	TECH MATH III	04	MTW F	8.00	1	LRC 207	REED,W	
	4475	1.127	STUDY SKILLS MATH 0-3 CREDITS	03		TBA			MILLER,J	
PHYSICAL SCIENCES										
P	4480	4.205	BASIC CHEM	04	M W F	8.00	1	ST 119	PERKINS,R	OPT
	4481		LAB 1		T	8.00	2	ST 106	PERKINS,R	
	4482		LAB 2		T	10.00	2	ST 106	PERKINS,R	
P	4485	CH104	GEN CHEM	05	M W F	11.00	1	ST 119	KRAFT,J	
	4486		LAB 1		T	8.00	3	ST 117	KRAFT,J	
	4487		LAB 2		H	8.00	3	ST 117	KRAFT,J	
	4488		REC 1		T	11.00	1	ST 217B	KRAFT,J	
	4489		REC 2		H	11.00	1	ST 109	KRAFT,J	
P	4490	CH226	ORGANIC CHEM	03	T-H	12.00	1.5	ST 109	HAYGARTH,J	
P	4495	CH201	GEN CHEM LAB	04	M W F W	9.00 2.00	1 3	ST 109 ST 117	KRAFT,J KRAFT,J	
	4500	GS104	PHYS SCIENCE LAB	04	M W F H	9.00 8.00	1 2	ST 119 ST 120	PERKINS,R PERKINS,R	
P	4505	P 201	GEN PHYSICS REC	04	M W F T	10.00 8.00	1 1	ST 120 ST 120	RASMUSSEN,S RASMUSSEN,S	
	4506		LAB 1		T	9.00	2	ST 120	RASMUSSEN,S	
	4507		LAB 2		T	1.00	2	ST 120	RASMUSSEN,S	
P	4510	P 201	GEN PHYSICS CANNOT BE COMBINED	04	M W	7.00 N 3		ST 120	RASMUSSEN,S	WITH DAY TIME CLASS
	4515	4.300	PRACT PHY REF/AC LAB	04	M W F H	9.00 10.00	1 2	ST 120 ST 120	RASMUSSEN,S RASMUSSEN,S	
	4520	4.300	PRACT PHYSICS E/E	04	M W F	2.00	1	ST 119	RASMUSSEN,S	
	4521		LAB 1		M	3.00	2	ST 120	RASMUSSEN,S	
	4522		LAB 2		W	3.00	2	ST 120	RASMUSSEN,S	

## LEARNING SERVICES DIVISION

READING										
	4525	1.135	DVLPNTL READING	03	M W F	9.00	1	LRC 202	MANN,C	PNP
	4530	1.135	DVLPNTL READING	03	M W F	10.00	1	LRC 217	GREGORY,R	PNP
	4535	1.135	DVLPNTL READING	03	M W F	11.00	1	LRC 202	MANN,C	PNP
	4540	1.135	DVLPNTL READING	03	M W F	1.00	1	LRC 217	COPE,M	PNP
	4545	1.135	DVLPNTL READING	03	M	7.00 N 3		LRC 202	GREGORY,R	PNP
	4550	1.135	DVLPNTL READING	03	T-H	1.00	1.5	LRC 205	GREGORY,R	PNP
	4555	EN115	EFFECTIVE READNG	03	M W F	1.00	1	LRC 202	MANN,C	OPT
	4560	EN115	EFFECTIVE READNG	03	T-H	1.00	1.5	LRC 202	MANN,C	OPT
	6235	EN115	EFFECTIVE READING SEE BENTON CENTER LISTING FOR THIS TLN							

STUDY SKILLS										
	4565	1.125	STUDY SKILLS	03	M W F	9.00	1	LRC 217	COPE,M	PNP
	4570	1.125	STUDY SKILLS	03	T-H	9.30	1.5	LRC 217	COPE,M	PNP
	4575	1.130	BASIC GRAMMAR	03	M W F	11.00	1	LRC 217	COPE,M	PNP

P	COURSE		START			RM		INSTRUCTOR	P/NP	
	TLN	NUMBER	CR	MTWHF	TIME	N	DUR			LOC
INDIVIDUALIZED COURSES										
NOTE - STUDENTS SIGNING UP FOR LANGUAGE ARTS										
OR READING SKILLS SHOULD REPORT TO LRC 202										
DURING THE FIRST WEEK OF CLASSES.										
	4580	1.126	LANG ART SKILLS	00		TBA		LRC 202	STAFF	PNP
	4585	1.126	LANG ART SKILLS	03		TBA		LRC 202	STAFF	
			1-3 CREDITS							
	4590	1.128	READING SKILLS	00		TBA		LRC 202	STAFF	PNP
	4595	1.128	READING SKILLS	03		TBA		LRC 202	STAFF	
			1-3 CREDITS							

## ARMY RESERVE OFFICERS TRAINING

SEE REGISTRAR FOR SPECIAL ADMISSION PROCEDURES

4600	MS111	MILITARY SCIENCE	01			TBA				
4605	MS111	MILITARY SCIENCE	02			TBA				

## GUIDANCE SERVICES

4610	0.685	LIFE PLNG/WOMEN	02	T	9.30	2		CC 110C	BREM,J	PNP
4615	0.685	CAREER DEC MAKING	03	T-H	9.30	1.5		F 204	COOPER,V	PNP
4620	PY111	PERSONAL DVLPMT	03	T-H	1.00	2		CC 110C	WALKER/OTTO	PNP
4625	ED207	LEADERSHIP SEM	02		TBA				GREEN,J	PNP
4630	ED209	LEADERSHIP PRAC	01		TBA				GREEN,J	PNP
4635	0.695	ASSERTIVENESS TRN	01	H	9.30	1.5		CC 110C	EASTON/BREM	PNP
		FOR WOMEN + MEN								
		5 WEEKS STARTS 9/30/75								
4640	0.695	ASSERTIVENESS TRN	01	H	9.30	1.5		CC 110C	EASTON/BREM	PNP
		FOR WOMEN + MEN								
		5 WEEKS STARTS 11/4/75								
6130	0.890	UNDERSTND YR CHLD	02	H	7.00	N 2		O 116	MANN,J	PNP
6135	0.890	UNDERSTND YR CHLD	02	T	7.00	N 2		CC 110C	MANN,J	PNP
6140	0.890	UNDERSTND YR CHLD	02	H	9.30	2		IA 201A	MANN,J	PNP
7340	0.688	SPECIAL PROB	00	F	3.00	2		CC 110C	WALKER,A	
		SOCIAL RE-ENTRY								
		PREREQUISITE - INSTRUCTOR APPROVAL								

## COOPERATIVE WORK EXPERIENCE

A PROGRAM WHICH SUPPORTS MAJOR AREAS OF STUDY BY ALLOWING STUDENTS TO EARN CREDIT TOWARD THEIR DEGREE BY WORKING IN THE FIELD AT A JOB THAT PARALLELS THEIR MAJOR, AND FOR ATTENDING A FIELD EXPERIENCE SEMINAR WHICH MEETS FOR 1 HOUR EA WK.

SEE THE COOPERATIVE WORK EXPERIENCE COORDINATOR FOR REGISTRATION DETAILS

SEMINAR SCHEDULE  
CWE COORDINATOR APPROVAL

4645	1.201	FIELD EXP SEMINAR	01	H	2.00	1		LRC 211	CLEMONS,M	
4650	1.201	FIELD EXP SEMINAR	01	H	7.00	N 1		LRC 209	CLEMONS,M	
4655	1.201	FIELD EXP SEMINAR	01		TBA					

P	COURSE		START				RM						
	TLN	NUMBER	COURSE	TITLE	CR	MTWHF	TIME	N	DUR	LOC	RM	INSTRUCTOR	P/NP
<b>COMMUNITY EDUCATION</b>													
APPRENTICESHIP													
FOR INDENTURED APPRENTICES ONLY													
5505	9.083	INTRO	ELECTRICITY	06	M	H	7.00	N	3	LRC	117	HINES,J	PNP
5510	9.089	IND	ELEC I	06	M	H	7.00	N	3	LRC	207	ORTIZ,E	PNP
5515	9.060	MACHINIST	APP	04	T	H	7.00	N	3	IB	118	BARTRAM,W	
5520	9.081	INSIDE	WIREMAN	06	M	W	7.00	N	3	H	121	STAFF	PNP
5525	9.081	INSIDE	WIREMAN	06	M	W	7.00	N	3	IA	212	STAFF	PNP
ALBANY CENTER													
MIKE PATRICK, DIRECTOR CC-106, LBCC CAMPUS PHONE 926-6035													
6005	9.818	HRSMNSHP/HRS	HSBN	03		W	7.00	N	2	ST	211	MOELLER,A	OPT
						SAT	9.00		3	ST	211		
6010	9.268	REAL	EST LIC PREP	03		H	7.00	N	3	B	104	LANGLO,J	PNP
6015	9.278	MOD	TRNDS REL/EST	01		W	7.00	N	3	O	202	STAFF	PNP
			4 WEEKS STARTS 10/15/75										
6020	9.275	TRANS	TRAF MGMT	5	03	T	7.00	N	3	B	101	CAMPBELL,R	OPT
6025	9.264	INTRST	COMM LAW	3	03	M	7.00	N	3	B	101	CAMPBELL,R	OPT
6030	9.291	REAL	ESTATE LAW	03		T	7.00	N	3	B	104	LAYMAN,B	PNP
			TESTING FEE \$7.50										
6035	9.535	LGL	ASST TECH/INT	03		T	7.00	N	3	F	204	RYAN,T	OPT
6040	9.277	REAL	EST APPRAISL	03		W	7.00	N	3	LRC	211	LAYMAN,B	PNP
6045	9.901	TAILORING		02		T	7.00	N	3	IA	201A	STAFF	
6050	0.686	I'M	OK, Y'R OK	03		M	7.00	N	3	B	107	JONES,D	
6055	0.686	APP	TRANS ANALYS	03		H	7.00	N	3	CC	110C	JONES,K	
6060	9.645	SCI	GLASS BLOWING	03		T-H	7.00	N	3	ST	117	BOSCHETTO,M	PNP
P 6065	3.530	REF/A-C	FUND	05		M W	7.00	N	2.5	IA	231	STAFF	
6070	4.100	BLUPRNT	READNG	02		T-H	7.00	N	2	ST	102	STAFF	
6075	6.550	PRE-TECH	MATH	04		M W	7.00	N	2	LRC	217	BACKEUS,D	
6080	6.158	SAN	SEM (WATER)	02		W	7.00	N	2	IA	224	ARASMITH,E	
6085	6.158	SAN	SEM-WSTWTR	02		H	7.00	N	2	IA	210	ARASMITH,E	
6090	9.310	FIRE	FGHT SKL A	02			TBA					WRIGHT,G	
6095	9.311	FIRE	FGHT SKLS B	02			TBA					WRIGHT,G	
6100	6.320	ELECT/ELECTRON	I	03		T	7.00	N	3	IA	237	HANSEN,K	
P 6105	6.321	ELECT/ELECTRON	II	03		T	7.00	N	3	IA	237	HANSEN,K	
P 6110	6.322	ELEC/ELECTRON	III	03		T	7.00	N	3	IA	237	HANSEN,K	
P 6115	6.323	ELECT/ELECTRON	IV	03		T	7.00	N	3	IA	237	HANSEN,K	
P 6120	6.324	ELECT/ELECTRON	V	03		T	7.00	N	3	IA	237	HANSEN,K	
P 6125	6.325	ELECT/ELECTRON	VI	03		T	7.00	N	3	IA	237	HANSEN,K	
6130	0.890	UNDERSTND	YR CHLD	02		H	7.00	N	2	O	116	MANN,J	PNP
6135	0.890	UNDERSTND	YR CHLD	02		T	7.00	N	2	CC	110C	MANN,J	PNP
6140	0.890	UNDERSTND	YR CHLD	02		H	9.30		2	IA	201A	MANN,J	PNP
6145	9.620	BASIC	RADIO ELECT	02		W	7.00	N	3	B	104	LEE,R	PNP
			THEORY										

P	COURSE		START				RM		INSTRUCTOR	P/NP	
	TLN	NUMBER	COURSE TITLE	CR	MTWHF	TIME	N	DUR			LOC
CENTRAL LINN											
	6150	9.813	AG CHEM STARTS 11/6/75 CONTINUES WINTER TERM	03	H	7.00	N	3	CLHS 801	JOHNSON,H	OPT
	6155	9.151	WELDING, BEG ARC + ACETELYNE	02	T	6.00	N	4	CLHS 801	RED,T	PNP
BENTON CENTER											
O. W. ZIELASKOWSKI, DIRECTOR 1235 NW PIERCE WAY, CORVALLIS PHONE 753-1688											
	6160	9.283	REAL EST FINANCE TESTING FEE \$7.50	03	H	7.00	N	3	BC 2	LAYMAN,B	
	6165	9.268	RL EST LIC PREP	03	W	7.00	N	3	CHS 112	DAPP,A	
P	6170	2.505	TYPING SKL BLDG	03	T-H	7.00	N	2.5	CHS 102	WILLIAMSON,V	
P	6175	SS124	TYPING SKL BLDG	03	T-H	7.00	N	2.5	CHS 102	WILLIAMSON,V	
	6180	2.541	SHORTHAND I	03	M W	7.00	N	2.5	CHS 101	WILLIAMSON,V	
	6185	SS111	SHORTHAND I	03	M W	7.00	N	2.5	CHS 101	WILLIAMSON,V	
P	6190	2.542	SHORTHAND II	03	M W	7.00	N	2.5	CHS 101	WILLIAMSON,V	
P	6195	SS112	SHORTHAND II	03	M W	7.00	N	2.5	CHS 101	WILLIAMSON,V	
	6200	9.500	ELEM /SUPERVISION	03	M	7.00	N	3	PHS	STAFF	
	6205	0.686	I'M OK, Y'R OK	03	H	7.00	N	3	FCC	JONES,D	
	6210	1.110	ELEM OF ALGEBRA	04	T-H	7.00	N	2	CHS 107	JORGENSON,S	
P	6215	MT102	TRIGONOMETRY	04	M W	7.00	N	2	CHS 107	LINDSTROM,T	
	6220	9.645	SCIENTIFIC GLS BL	03	M H	7.00	N	3	CHS 114	MEEKER,W	PNP
	6225	PE185	BALLET, BEG	01	M H	8.30	N	1.5	CWC	IRWIN,B	
P	6230	PE185	BALLET, ADV	01	M H	7.00	N	1.5	CWC	IRWIN,B	
	6235	EN115	EFFECTIVE READING	03	W	7.00	N	3	CHS 111	CARLSON,R	
	6240	GE105	INTRO GEOGRAPHY	03	W	7.00	N	3	CHS 206	TOLLE,T	
	6245	SO204	GEN SOCIOLOGY	03	W	7.00	N	3	CHS 108	LIEBERMAN,M	
	6250	PY201	GEN PSYCHOLOGY	03	M	7.00	N	3	CHS 206	ALLEN,J	
	6255	HS101	WESTERN CIV	03	W	7.00	N	3	CHS 203	BARNES,R	
	6260	AN101	GEN ANTHROPOLOGY	03	T	7.00	N	3	CHS 203	DUNN,L	
	6265	EN104	INTRO TO LIT	03	T	7.00	N	3	CHS 108	BARNES,C	
	6270	WR121	ENG COMP	03	H	7.00	N	3	CHS 203	BARNES,C	
	6275	9.151	WELDING I CLASS LIMITED - PRE-REGISTRATION REQUIRED	02	T	6.30	N	4	CVHS F50	HONEY,C	
	6280	9.151	WELDING I CLASS LIMITED- PRE-REGISTRATION REQUIRED	02	H	6.30	N	4	CVHS F50	PATTON,D	



P	COURSE		START			RM		INSTRUCTOR	P/NP		
	TLN	NUMBER	COURSE TITLE	CR	MTWHF	TIME	N			DUR	LOC
SANTIAM CENTER											
MONA WAIBEL, COORDINATOR 1314 LONG ST, SWEET HOME PHONE 367-4242											
	6285	AR195	BASIC DESIGN	03	H	7.00	N	3	SHHS	WOOD,J	
	6290	2.541	STENO I	03	T-H	7.00	N	2.5	SHHS	AUSTIN,L	
	6295	2.509	INTRO COMPUTERS	03		TBA			SHHS	STAFF	
P	6300	2.542	STENO II	03	T-H	7.00	N	2.5	SHHS	AUSTIN,L	
	6305	0.686	I'M OK, Y'R OK	03	T	7.00	N	3	SHHS	SHOEMAKE,B	
	6310	WR121	ENG COMP	03	M	7.00	N	3	SHHS C7	GAGE,M	
	6315	EN104	INT TO LIT	03	W	7.00	N	3	SHHS C7	GAGE,M	
	6320	B0201	GEN BOTANY	04	M W	6.00	N	3	SHHS	CHAMBERS,H	
	6325	PY201	GEN PSYCH	03	M	7.00	N	3	SHHS	GENTRY,S	
	6330	9.151	WELDING	02	T	6.00	N	4	SHHS	HAVERKATE,T	OPT
	6335	4.100	BLU-PRNT READING	02	H	6.00	N	4	SHHS C14	HAVERKATE,T	OPT
P	6340	9.611	PRINT METHOD II	02	W	7.00	N	3	TELL SELL	SHOEMAKE,B	
EAST LINN CENTER											
BILL JORDAN, DIRECTOR 1715 SOUTH FIFTH, LEBANON PHONE 259-1886											
	6345	9.817	LVSTK CARE/MNGT	02	W	7.00	N	3	LHS 64	COOPER,S	
	6350	9.739	OFFICE PROCEDURES	02	M	7.00	N	3	LHS 8	SAWTELLE,D	OPT
	6355	2.530	PRACT ACCT I	03	W	7.00	N	3	LHS	STAFF	OPT
	6360	WR242	INTRO IMAG WRT	03	T	7.00	N	3	LHS	SWEET,W	
	6365	WR121	ENG COMP	03	W	7.00	N	3	LHS	MCCRANN,T	
	6370	EN104	INTRO TO LIT	03	T	7.00	N	3	LHS	MCCRANN,T	
P	6375	MT161	MATH/NON-SCI MJRS	04	T-H	7.00	N	2	LHS	STAFF	
	6380	9.151	WELDING I	02	T	6.00	N	4	LHS SHOP	ELDER,W	OPT
	6385	9.152	WELDING II	02	W	6.00	N	4	LHS SHOP	ELDER,W	OPT
	6390	4.100	BLUEPRINT RDG	02	W	6.00	N	4	LHS 93	HUGHES,J	OPT
SCIO											
	6395	WR121	ENG COMP	03	T	1.00		3	JANZ BLDG	STAFF	
P	6400	MT 95	INTERMED ALGEBRA	04	T-H	9.00		2	JANZ BLDG	STAFF	
	6405	S0204	GEN SOCIOLOGY	03	T	9.00		3	JANZ BLDG	STAFF	

### GUIDANCE & COUNSELING SERVICES

The following students are required to have counselor approval of their programs:

1. New students who are registering for 8 or more credit hours
2. Students being sponsored by a special program, such as MDTA, DVR, WIN, etc.
3. Students on probation or in danger of failure
4. Students changing their major

In addition, any student who wishes counseling assistance in planning his program is encouraged to contact a faculty advisor or the Guidance Center for an appointment.

### FINANCIAL AIDS

Students needing financial assistance (grant, loan, or campus employment) should contact the Financial Aids Office as soon as possible. Applicants for financial aids are judged on (1) need, (2) date of application, and (3) aptitude based on interest and past performance.

### NON-ATTENDANCE

Students who are unable to attend a class regularly may jeopardize their enrollment in that class. If you must miss a class, you should contact the instructor immediately. During the term the College is making adjustments in the class registrations, and other students are waiting to enroll.

### PASS GRADING

Certain courses listed in the schedule have an "OPT" designation in the PNP column. Each student in that class has the option of taking the course for the usual A, B, C, D, or F grade or taking it on a pass/no pass basis. On these courses only, the student may request a P/NP Option Form from the instructor any time during the quarter up to the last day of regular classes. Once the P/NP has been elected, the student may not change back to regular grading without the permission of the instructor. If uncertain about requesting the P/NP, the student should wait until the last day to make a decision.

Courses listed in the schedule with "PNP" in that column are those where only pass or no pass grades are issued.

The maximum of "P" credits allowed toward an LBCC degree will be 16 hours, not including those with mandatory pass (P) grading. Students should consult with a counselor before deciding to choose the pass (P) grade. It is not advisable for a student to choose the "P" grade in a course that is considered a major course in his field of study. Students planning to transfer to a four-year institution should check that institution's requirements regarding the "P".

### ADDING CLASSES

To add a class, an add slip must be presented at the Registration Office and any additional tuition paid. Students taking 8 or more credit hours may add classes through the first week on a space-available basis. Students carrying a total of 7 or less credit hours may add classes during the first two weeks on a space-available basis. However, adding classes during the second week requires written permission of the instructor. There is no add fee for the first change of schedule involving one or more added classes. The charge for each additional change is \$2.

### DROPPING CLASSES

To officially drop a class requires presentation of a drop slip at the Registrar's Office. Students who withdraw without giving written notice to the Registration Office will forfeit all claims to refund of tuition and will remain responsible for their grade in the class. Students who withdraw from all their classes must also complete a "Total Drop Form" at the Registrar's Office.

### REFUNDS

To receive a refund, students must submit a drop slip to the Registration Office within the first five weeks of the term. Refunds will be mailed after the second week of classes.

The amount of refund:

- Official withdrawal by a student carrying 8 or more credits = full refund less \$15.
- Official withdrawal by a student carrying 7 or less credits = full refund less \$5.
- Official withdrawal by a student paying \$8.75 or enrolled in Community Education non-credit classes = full refund less \$2.50.
- Reduction of credit load = difference in tuition amounts (to the minimum charge)
- Classes cancelled by the college = full refund or re-enrollment in another class providing student notifies registration office.

### INSURANCE

Hospitalization and accident insurance is available to all students at the time of registration. Brochures giving details of this coverage are available in the Registration Office. Premium must be paid at time of registration and prior to the second week of the term.

### JOB PLACEMENT

Part-time and career-job-placement assistance is available to students of LBCC. Students needing employment should contact the Placement Officer in the Financial Aids Office.

### LEARNING RESOURCE CENTER

The Learning Resource Center is a multi-purpose facility meeting the instructional need of faculty and the learning needs of students at LBCC. The LRC includes the college library which has approximately 25,000 volumes. It is also the headquarters for campus Media Services which encompasses films, filmstrips, audio-tape programming, television and other forms of educational media. Reading and mathematics labs are operated as portions of the LRC. The graphics department of the LRC offers printing, photography, and art design services to the campus. The staff of the LRC are responsible for assisting students in locating and utilizing available materials.

### GOLDEN AGE CLUB

Senior citizens (65 years and older) may wish to acquire an LBCC Golden Age Card. The bearer of the card is granted tuition and fee waivers to most college classes on a space available basis, and all college activities. The cards are available in the Community Education Office.

# INDEX

	Page		Page
Adding Classes .....	i	Guidance & Counseling Services .....	i
Admissions .....	i	Health .....	8
Agriculture Technology .....	19	Heating, Air Cond. & Refrig. Technology .....	22
Air Conditioning, Heating & Refrigeration Tech.....	22	History .....	18
Albany Center Community Education .....	26	Human Services .....	17
Allied Health & PE Division .....	6	Humanities & Social Services Division.....	14
Animal Science .....	20	Industrial & Business Division.....	8
Anthropology .....	18	Insurance.....	i
Apprenticeship .....	26	Job Placement .....	ii
Army Reserve Officers Training .....	25	Journalism .....	15
Art .....	14	Law Enforcement (see Criminal Justice) .....	15
Associate Degree Nursing .....	6	Learning Resource Center .....	i
Auto Body Repair .....	12	Learning Services Division .....	24
Automotive Technology .....	12	Lebanon Classes .....	29
Banking & Finance .....	9	Literature (See English-Journalism) .....	15
Benton Center .....	27	Machine Tool Technology .....	12
Biological Sciences .....	20	Major Code List .....	4
Business & Industrial Division .....	8	Mathematics .....	23
Business Management .....	8	Metallurgical Technology .....	13
Business Skills .....	10	Music .....	17
Campus Map .....	Inside Front Cover	Non-Attendance .....	i
Carpentry .....	14	Nursing, Associate Degree .....	6
Central Linn Classes .....	27	Nursing Assistant .....	6
Child Care (see Human Services) .....	17	Pass Grading .....	i
Civil/Mechanical Technology .....	21	Philosophy and Religion .....	18
Class Location Key .....	5	Physical Education .....	7
Community Education Division .....	26	Physical Science .....	24
Construction Tech./Carpentry .....	14	Plant Science .....	19
Cooperative Work Experience .....	25	Political Science .....	18
Corvallis Classes .....	28	Psychology .....	19
Counseling .....	i	Reading .....	24
Criminal Justice Administration .....	15	Recreational Vehicle Repair .....	13
Data Processing .....	11	Refrigeration, Heating & Air Conditioning .....	22
Dental Assistant .....	7	Refunds .....	i
Drafting Technology .....	21	Registration Information .....	2
Drama-Speech .....	15	Reg. Office Hours .....	Inside Back Cover
Dropping Classes .....	i	Religion and Philosophy .....	18
East Linn Center .....	28	Sample Registration .....	4
Economics .....	18	Santiam Center .....	28
Education .....	18	Schedule Key .....	6
Electricity/Electronics Technology .....	21	Science Laboratory Technology .....	22
Engineering Technology .....	21	Science and Technology Division .....	19
English-Journalism-Foreign Language .....	15	Scio Classes .....	28
Environmental Science Tech. ....	22	Small Business Management .....	9
Family Living .....	18	Small Engine/Recr. Vehicle Repair .....	13
Farm Management .....	20	Social Science .....	18
Fee Schedule .....	5	Social Services & Humanities Division .....	14
Financial Aids .....	i	Sociology .....	19
Fire Science .....	22	Speech-Drama .....	15
Food Services .....	12	Study Skills .....	24
Foreign Language .....	15	Supervisory Training .....	9
General Engineering .....	22	Sweet Home Classes .....	29
General Information .....	i	Table of Contents .....	1
Geography .....	18	Tuition Rates .....	5
Golden Age Club .....	i	Water/Wastewater Technology .....	22
Graphic Communications .....	17	Welding .....	13
Guidance Services (classes) .....	25	Wood Technology (see Const. Tech.) .....	14
		Writing (see English-Journalism) .....	15

## TRIAL SCHEDULE

(FOR PLANNING PURPOSES ONLY)

TERM LINE NUMBER	COURSE NO	COURSE NAME	CR.	M	T	W	TH	F	BLDG - RM	INSTRUCTOR

### FALL TERM 1975 CALENDAR

Registration for New and Continuing Students-----Aug. 25 - Sept 26  
 Classes Begin-----Sept. 29  
 Last Day to Register or Add Courses  
     Students Carrying 8 or More Credits-----Oct. 3  
     Students Carrying 7 or Less Credits-----Oct. 17  
 Last Day to Drop without "W"-----Oct. 10  
 Last Day for Refunds-----Oct. 31  
 Last Day to Request P/NP Option-----Dec. 12  
 Last Day to Officially Withdraw-----Dec. 12  
 Final Exams-----Dec. 15 - 17  
 Last Day of Fall Quarter-----Dec. 19  
 Winter Term Registration-----Dec. 1 - Jan 2  
 Winter Term Begins-----Jan. 5

### FALL TERM REGISTRATION OFFICE HOURS

Aug. 25 - Sept. 26-----8:30 am to 4:30 pm MONDAY through FRIDAY  
 Sept. 29 - Oct. 2-----8:00 am to 8:30 pm MONDAY through THURSDAY



# **LINN-BENTON COMMUNITY COLLEGE**

6500 S.W. PACIFIC BLVD., ALBANY, OREGON 97321